



ROAD DEPARTMENT

ADDENDUM NO. 1

SIX CORNERS IRRIGATION PIPING IMPROVEMENT

The Bidding Documents for the Six Corners Irrigation Piping Improvement project are amended as follows:

SPECIAL PROVISIONS



1.) Replace Subsection 00180.50(h) of the Special Provisions with the following:

00180.50(h) Contract Time - There are two Contract Times on this Project as follows:

- (1) The Contractor shall complete all Work to be done under the Contract, except for paving, shouldering and fence work, not later than March 31, 2019.
- (2) The Contractor shall complete all Work to be done under the Contract not later than April 12, 2019.

2.) Add the following subsection to Section 00180 of the Special Provisions:

00180.85(b)(2) Multiple Contract Times - Add the following paragraph and bullet list to the end of this subsection:

The Agency determined percentages of the value of Work required to be complete by the Contract Times listed under 00180.50(h) are as follows:

- For Contract Time 00180.50(h)(1) the Agency determined percentage of Work is 100 percent.
- For Contract Time 00180.50(h)(2) the Agency determined percentage of Work is 100 percent.

SCHEDULE OF BID ITEMS

Replace the Schedule of Bid Items bound within the Bidding Documents with the attached Schedule of Bid Items.

PROJECT PLANS

Replace Sheets C1.2 and C1.3 bound within the Bidding plans with the attached Sheets C1.2 and C1.3.



Cody Smith, PE
County Engineer

12-4-18

Date

I acknowledge receipt of Addendum Number 1.

SIGNATURE OF BIDDER

Date

THIS ADDENDUM, COMPLETE WITH ATTACHMENTS, SHALL BE SUBMITTED WITH BID PROPOSAL.

ITEM NO.	SPEC SECTION	ITEM	UNIT	QTY	UNIT PRICE	AMOUNT
<u>Part 00200 - Temporary Features and Appurtenances</u>						
001	00210	Mobilization	LS	1	\$	\$
002	00225	Temporary Work Zone Traffic Control, Complete	LS	1	\$	\$
<u>Part 00300 - Roadwork</u>						
003	00305	Construction Survey Work	LS	1	\$	\$
004	00310	Removal of Pipes	Foot	355	\$	\$
005	00310	Removal of Structures and Obstructions	LS	1	\$	\$
006	00310	Asphalt Pavement Saw Cutting	Foot	215	\$	\$
007	00310	Removal of Surfacing	SY	225	\$	\$
008	00320	Clearing and Grubbing	LS	1	\$	\$
009	00330	Embankment In Place	CY	300	\$	\$
010	00390	Loose Riprap, Class 50	CY	8	\$	\$
<u>Part 00400 - Drainage and Sewers</u>						
011	00445	18 Inch PVC Pipe, 5 Foot Depth	Foot	10	\$	\$
012	00445	12 Inch PVC Pipe, 5 Foot Depth	Foot	1369	\$	\$
013	00470	Irrigation Inlet Structure 1, Complete	Each	1	\$	\$
014	00470	Irrigation Inlet Structure 2, Complete	Each	1	\$	\$
015	00470	Irrigation Outlet Structure, Complete	Each	2	\$	\$
<u>Part 00600 - Bases</u>						
016	00641	3/4 Inch - 0 Aggregate Base	Ton	115	\$	\$
<u>Part 00700 - Wearing Surfaces</u>						
017	00744	Level 3, 1/2 Inch Dense ACP Mixture	Ton	55	\$	\$
<u>Part 01000 - Right of way Development and Control</u>						
018	01050	Removing and Rebuilding Fence	Foot	25	\$	\$
<u>Part 01100 - Water Supply Systems</u>						
019	01140	Ductile Iron Pipe Bend, 12 Inch	Each	4	\$	\$
020	01140	12 Inch Pipe Cleanouts with Class B Backfill	Each	7	\$	\$
TOTAL BID:						_____

FOR DESCHUTES COUNTY USE ONLY	
ADD <u> </u> % FOR NON-RESIDENT BIDDER	_____
TOTAL BID	_____

The Bidder acknowledges receipt of the following Addenda: (insert addenda numbers)

No.____ No.____ No.____ No.____ No.____ No.____ No.____ No.____

PATH: U:\Bend\Projects\Clients\2509-Deerchutes County\297-2509-005 OBRH Design Phase\995\va\CADD\DWG\SW-CORNERS\CD'S
 LAYOUT: PP
 PLOTTED BY: rccoady DATE: Tuesday, December 4, 2018 8:46:55 AM

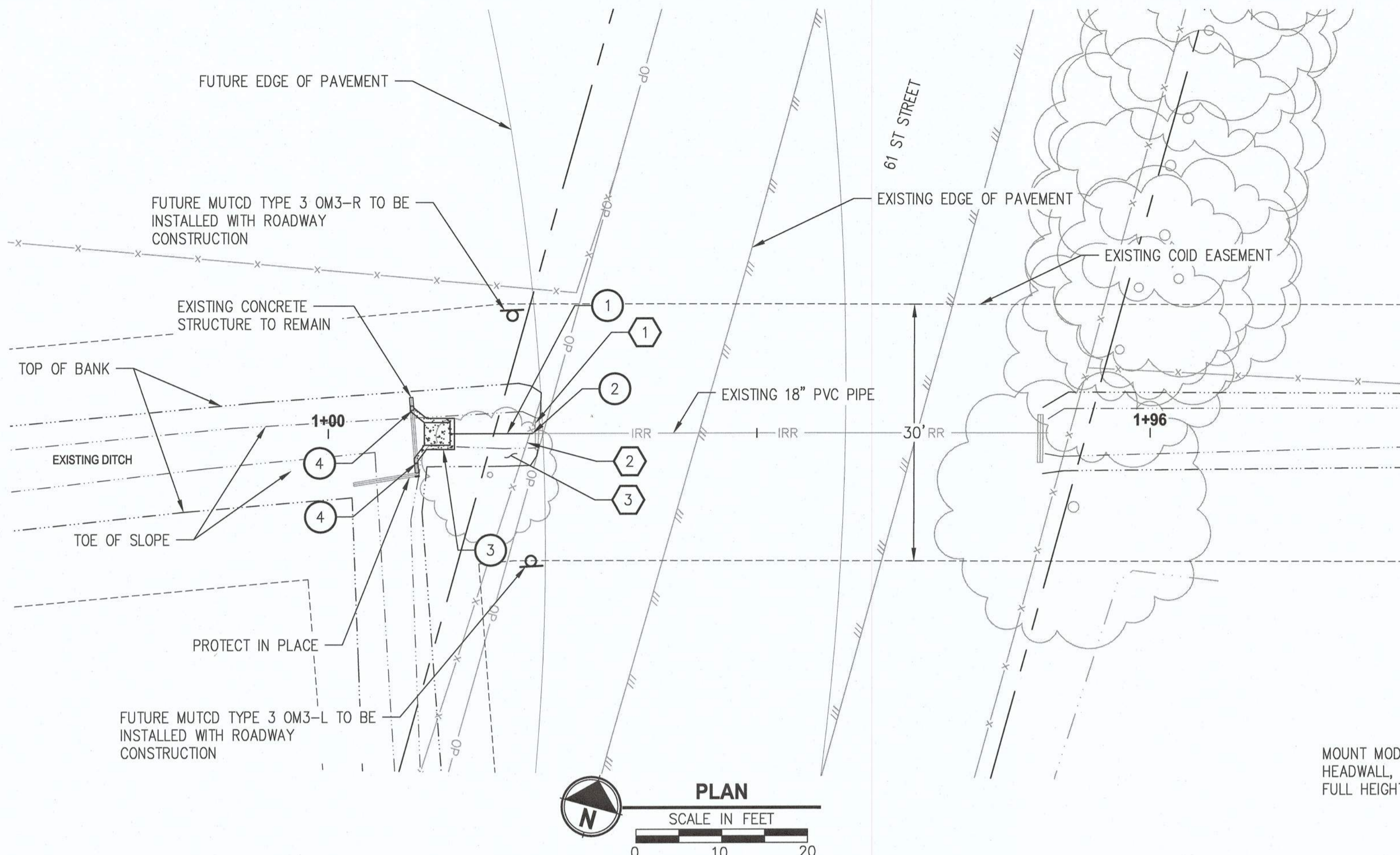

IRRIGATION CONSTRUCTION NOTES : ○

- 1.) INSTALL 18" DR 32.5 C900 PVC PIPE
- 2.) STA:1+23.80, 61ST; TIE INTO EXISTING 18" PVC PIPE WITH COUPLING ADAPTER
- 3.) STA: 1+14.20, 61ST; CONSTRUCT INLET STRUCTURE PER DETAIL 1/C1.2
- 4.) DRILL & INSTALL #4 DOWEL BARS @ ±12" OC TO TIE THE EXISTING CONCRETE STRUCTURE TO PROPOSED INLET STRUCTURE, SEE DETAIL 1 ON THIS SHEET

GENERAL CONSTRUCTION NOTES : ⊗

- 1.) REMOVE AND DISPOSE OF EXISTING CONCRETE IRRIGATION STRUCTURE, BACKFILL EXCAVATION WITH CLASS B MATERIAL IN ACCORDANCE WITH SPECIFICATIONS 00310
- 2.) REMOVE AND REPLACE EXISTING WIRE FENCE AS REQUIRED FOR IRRIGATION PIPE CONSTRUCTION
- 3.) REMOVE AND DISPOSE OF EXISTING TREES PER CLEAR AND GRUB SPECIFICATION 00320

SEE GENERAL CENTRAL OREGON IRRIGATION DISTRICT PIPING NOTES, SHEET C1.3

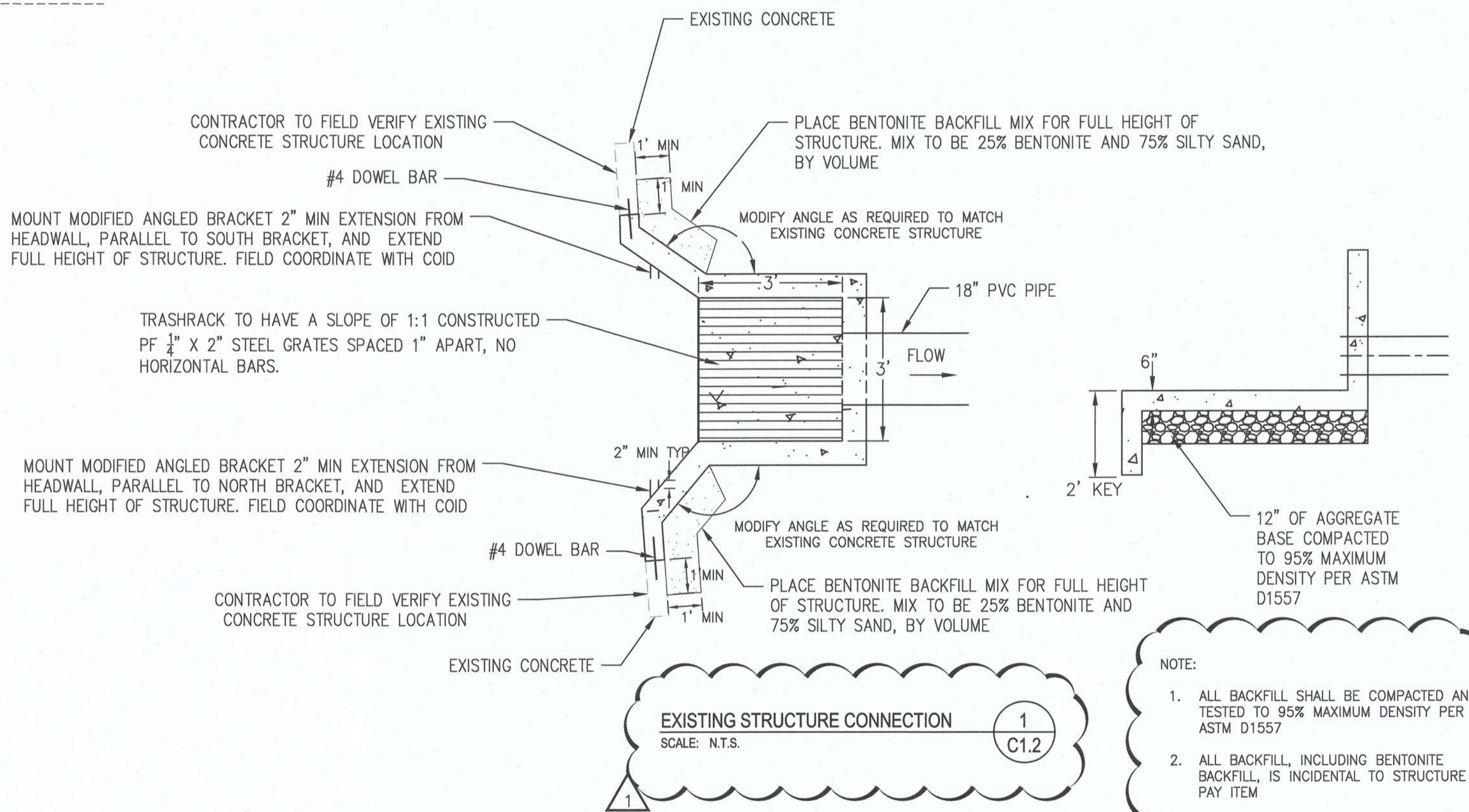

- NOTE:
1. ALL BACKFILL SHALL BE COMPACTED AND TESTED TO 95% MAXIMUM DENSITY PER ASTM D1557
 2. ALL BACKFILL, INCLUDING BENTONITE BACKFILL, IS INCIDENTAL TO STRUCTURE PAY ITEM
 3. ALL INLET AND OUTLET STRUCTURES TO BE REINFORCED WITH #4 BARS 12" OC EACH WAY.

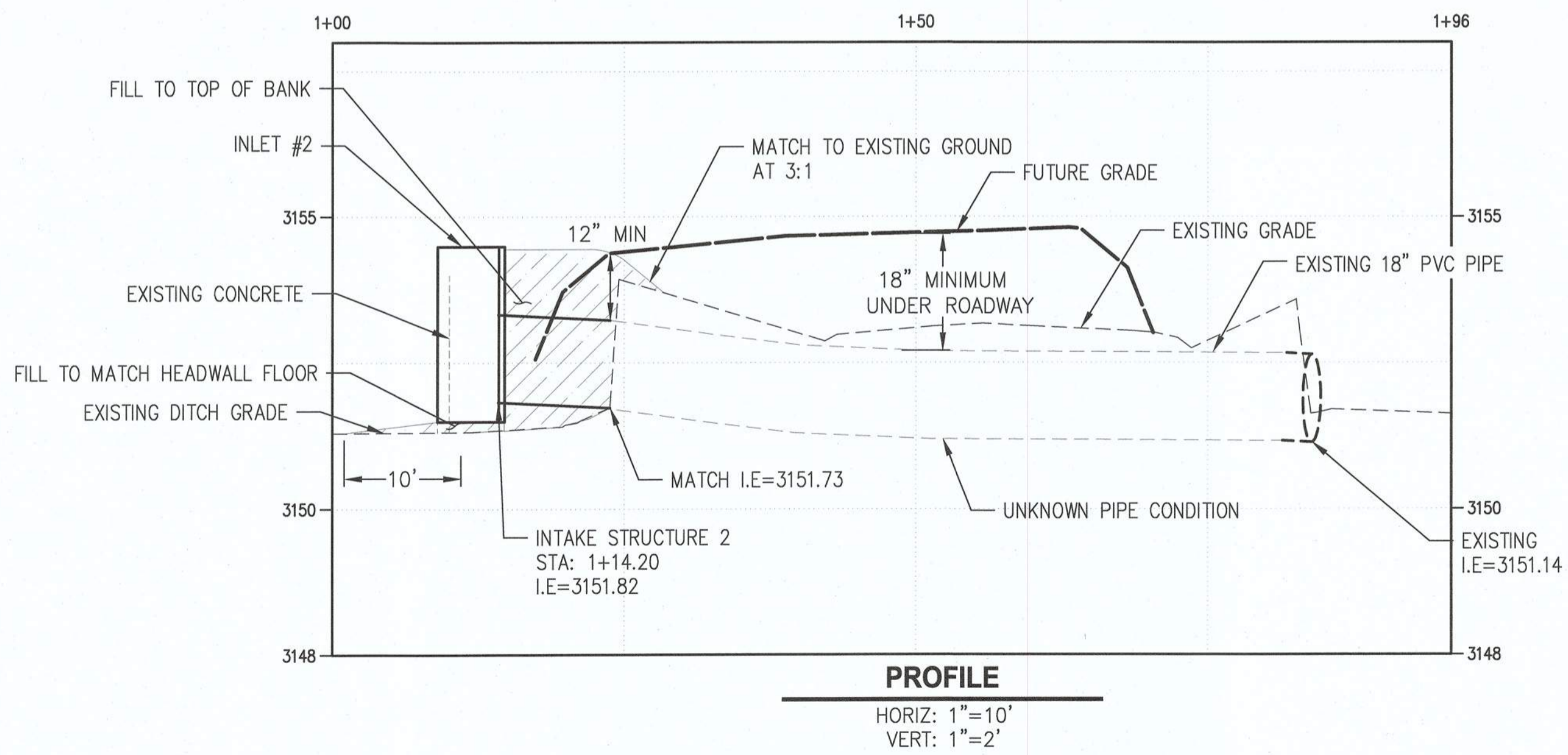

REVISIONS	DATE	BY	DESIGNED
1	12/4/18	DR	AE/DR
			AE/DR/LF
			CHECKED
			VALUE
			APPROVED
			VALUE

ONE INCH AT FULL SCALE, IF NOT, SCALE ACCORDINGLY

FILE NAME: BE-2509-005.3-C1.2-PP00-IRR

JOB No.

DATE



Parametrix
 ENGINEERING . PLANNING . ENVIRONMENTAL SCIENCES

150 NW PACIFIC PARK LANE, SUITE 110 | BEND, OR 97701
 P 541.508.7710
 WWW.PARAMETRIX.COM

PROJECT NAME
IRRIGATION IMPROVEMENTS

**PLAN AND PROFILE
 61ST STREET CROSSING**

DRAWING NO.
 3 OF 4
C1.2

LAYOUT: DETAILS
 PATH: U:\Bend\Projects\Clients\2509-Deschutes County\2509-005 OBRH Design Phase\985ves\CADD\DWG\SIX-CORNERS\CD'S
 PLOTTED BY: ricodov DATE: Tuesday, December 4, 2018 9:13:14 AM

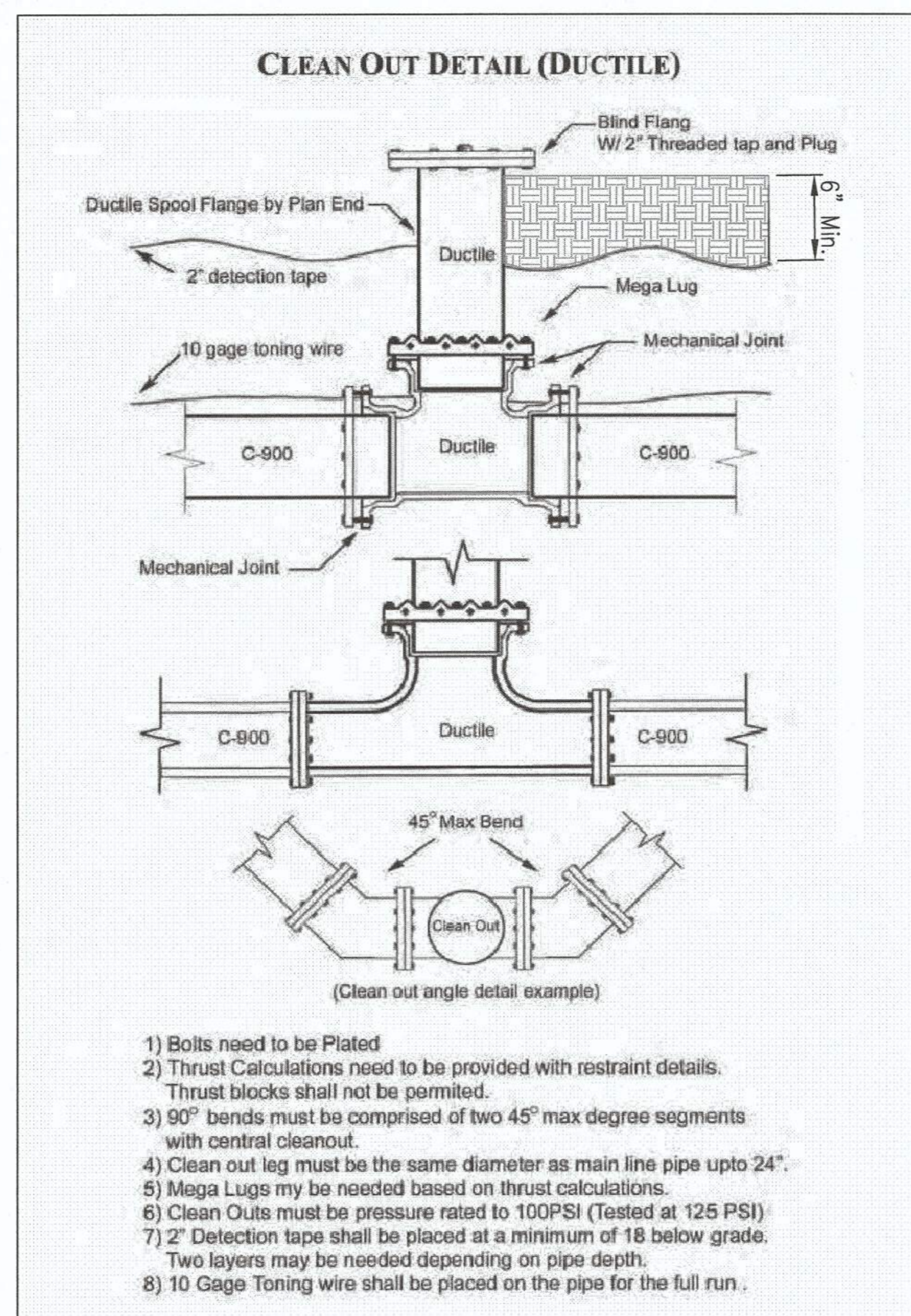
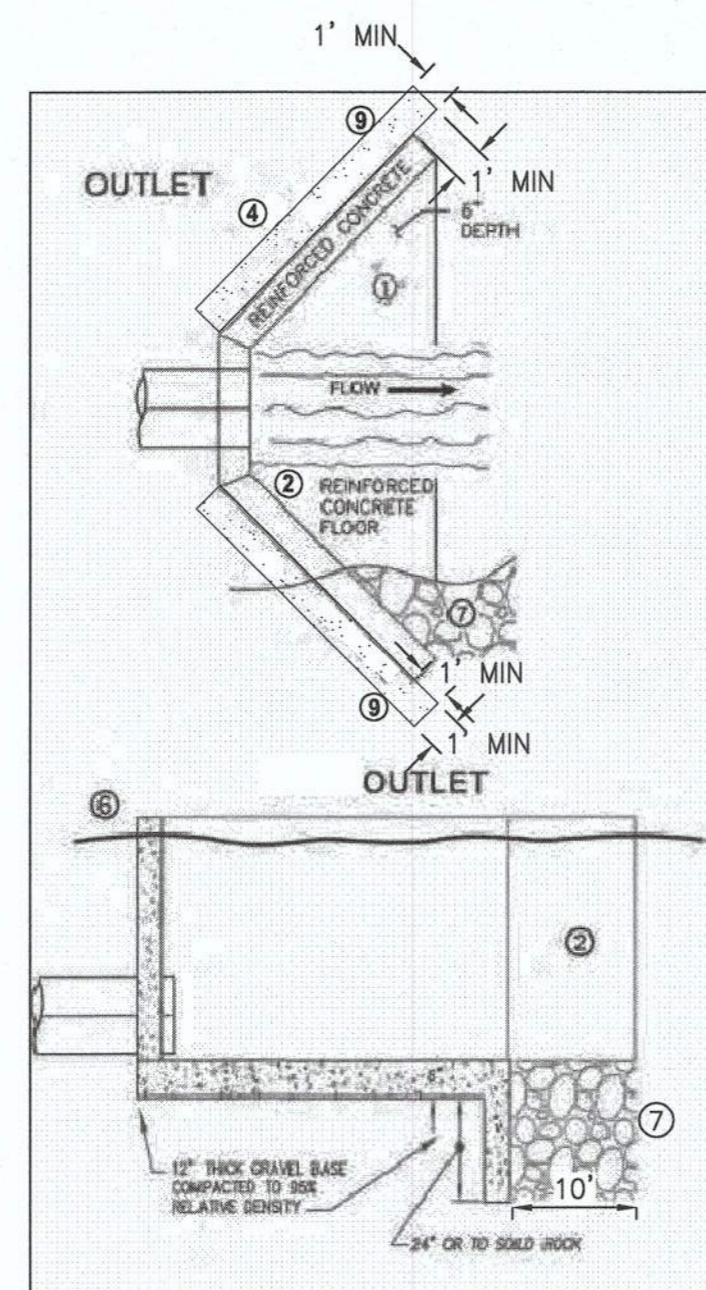
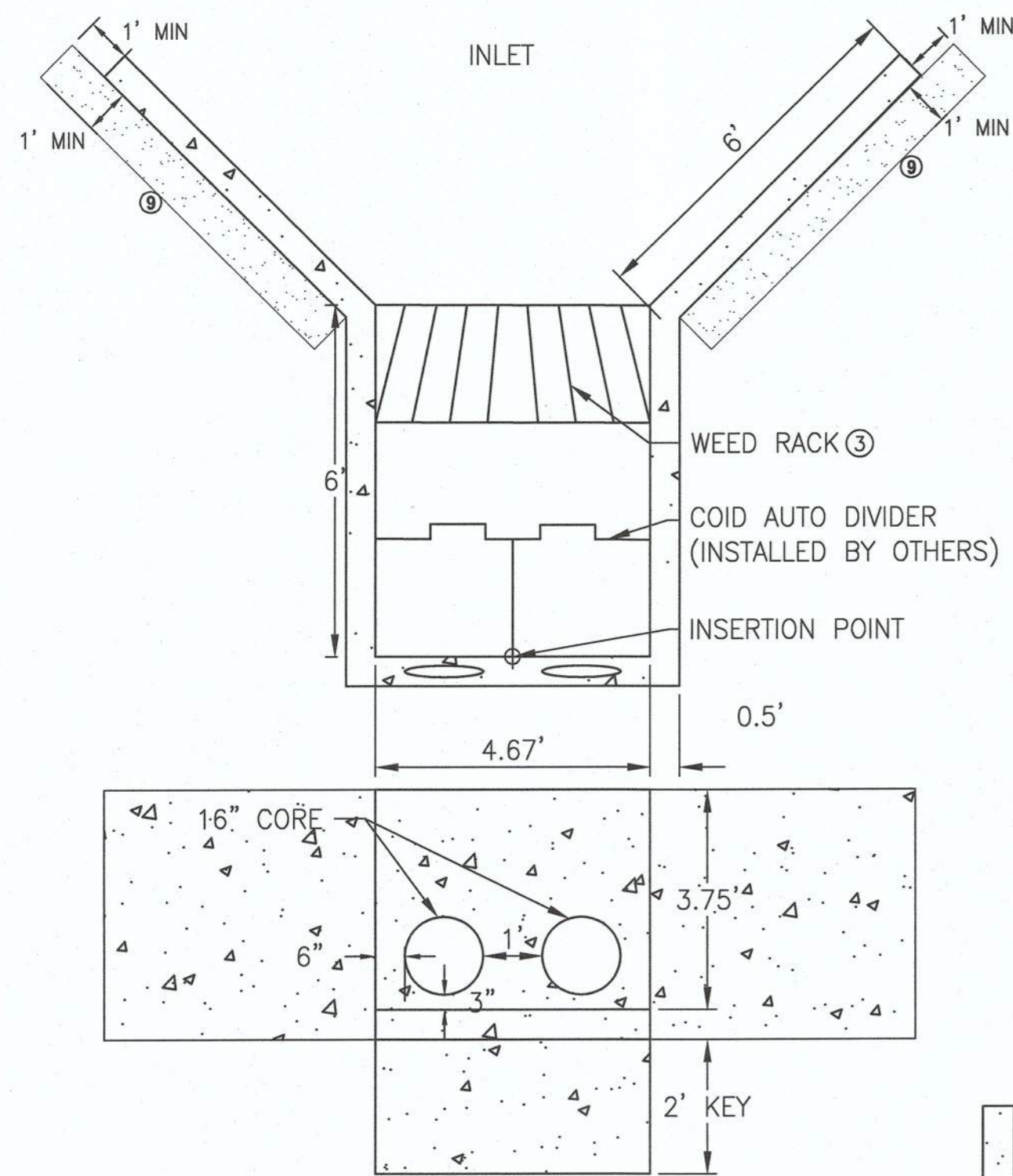

TYPICAL CLEAN OUT DETAIL
SCALE: N.T.S. 2
C1.3

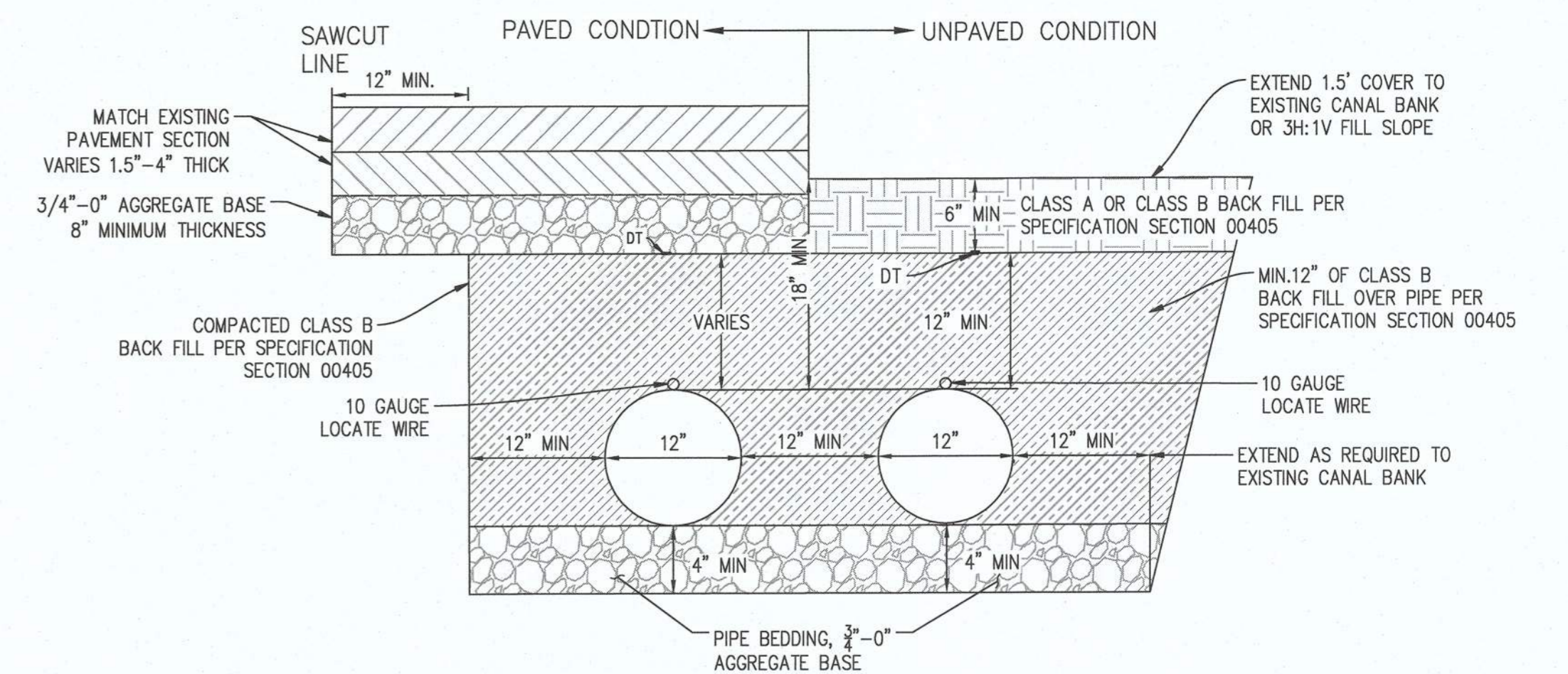

DOUBLE PIPE TRENCH DETAIL
SCALE: N.T.S. 3
C1.3

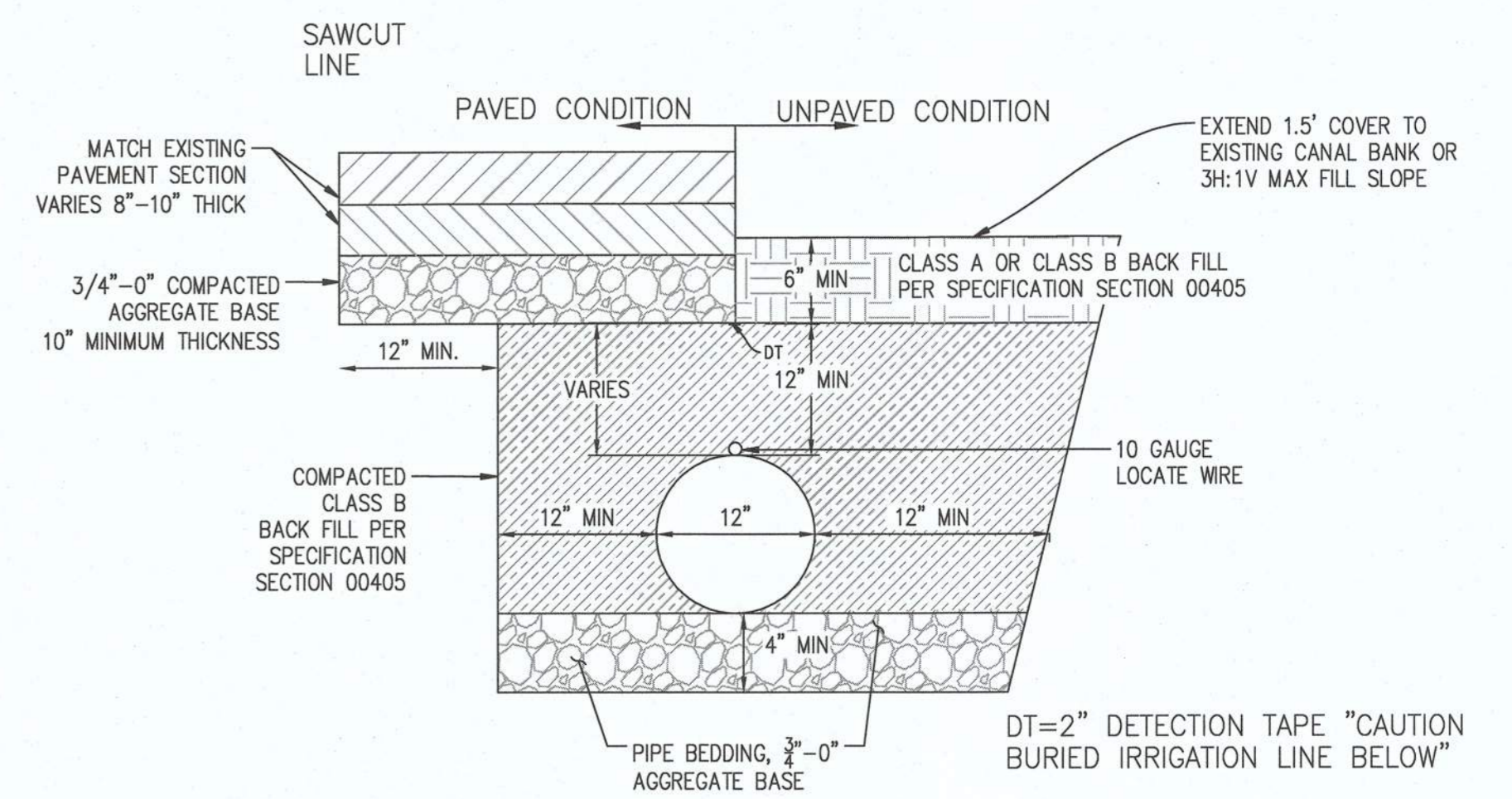

SINGLE PIPE TRENCH DETAIL
SCALE: N.T.S. 4
C1.3

- NOTE ① : CONCRETE FLOOR TIED TO WALL. TOP OF FLOOR TO BE FLUSH WITH CANAL FLOWLINE
- NOTE ② : WINGWALLS SHALL BE A MINIMUM OF 2 FEET INTO CANAL BANK
- NOTE ③ : TRASHRACK TO HAVE A SLOPE OF 1:1 CONSTRUCTED OF 1/2\" x 2\" STEEL GRATES SPACED 2\" APART-NO HORIZONTAL BARS. INSTALL ON INLET ONLY
- NOTE ④ : ALL BACKFILL SHALL BE COMPACTED AND TESTED TO 95% MAXIMUM DENSITY
- NOTE ⑤ : INSIDE WIDTH OF WALL TO BE MINIMUM OF (2 X PIPE DIAMETER)
- NOTE ⑥ : TOP OF WALL TO EXTEND A MINIMUM OF 3\" ABOVE CANAL BANK HIGH POINT
- NOTE ⑦ : ALL SIDE TO BE RIPRAPPED-CLASS 50 RIPRAP
- NOTE ⑧ : ALL BACKFILL, INCLUDING BENTONITE BACKFILL, IS INCIDENTAL TO STRUCTURE PAY ITEM
- NOTE ⑨ : PLACE BENTONITE BACKFILL MIX FOR FULL HEIGHT OF STRUCTURE . MIX TO BE 25% BENTONITE AND 75% SILTY SAND SOIL, BY VOLUME.
- NOTE ⑩ : ALL INLET AND OUTLET STRUCTURES TO BE REINFORCED WITH #4 BARS 12\" OC EACH WAY

TYPICAL INLET AND OUTLET HEADWALL DETAIL
SCALE: N.T.S. 1
C1.3

RESTRAINED LENGTH TABLE	
HORIZONTAL BEND	MIN. RESTRAINED LENGTH FROM END OF BEND
12\"- 45°	20'

TO DEVELOP MINIMUM RESTRAINED LENGTH, THE EBAA IRON RESTRAINT LENGTH CALCULATOR WAS USED WITH THE FOLLOWING ASSUMPTIONS:

THE MAINS ARE TO BE BACKFILLED AND COMPACTED PER SPECIFICATIONS, PIPE MATERIAL USED IS PVC, SOIL TYPE IS SM (SILTY SANDS, SAND SILT MIXTURES), A FACTOR OF SAFETY OF 1.5, TRENCH TYPE 5, AND DEPTH OF BURY 1.5 FT. DESIGN PRESSURE OF 100 PSI. IF THE DISTANCE BETWEEN FITTINGS IS LESS THAN OR EQUAL TO THE CALCULATED RESTRAINT LENGTH, RESTRAIN ALL JOINTS BETWEEN THOSE FITTINGS. IT IS THE CONTRACTORS RESPONSIBILITY TO ENSURE THE SYSTEM IS FULLY RESTRAINED IN AREA OF WORK.

RESTRAINED LENGTH TABLE
SCALE: N.T.S. 5
C1.3

CENTRAL OREGON IRRIGATION DISTRICT PIPING SPECIFICATIONS GENERAL NOTES:

1. ALL IRRIGATION PIPING SHALL BE CONSTRUCTED OF AWWA C900 PVC DR 32.5
2. THE CONTRACTOR SHALL PROVIDE ALL NECESSARY PERSONEL, EQUIPMENT, AND MATERIALS TO CONDUCT AN AIR TEST FOR ALL IRRIGATION PIPING IN ACCORDANCE WITH SECTION 00445.72 (C) OF THE PROJECT SPECIFICATIONS. THE CONTRACTOR SHALL NOTIFY THE ENGINEER A MINIMUM OF 48 HOURS PRIOR TO CONDUCTING THE PRESSURE TESTING.
3. CLEANOUTS SHALL BE THE SAME DIAMETER AS THE MAIN LINE AND CONSTRUCTED IN GENERAL ACCORDANCE WITH THE CLEANOUT DETAIL ON THIS SHEET.
4. ALL TRENCH EXCAVATION AND BACKFILL SHALL BE CONSTRUCTED IN ACCORDANCE TO 00330.41 (6) OREGON STD SPECIFICATIONS FOR CONSTRUCTION 2018
5. THE CONTRACTOR SHALL INSTALL 10 GAUGE TONING WIRE ALONG ALL IRRIGATION PIPE.
6. THE CONTRACTOR SHALL INSTALL 2 INCH WIDE "IRRIGATION" DETECTION TAPE AS SHOWN ON THE TYPICAL TRENCH DETAILS.
7. THE CONTRACTOR SHALL COORDINATE WITH COID TO SCHEDULE CONSTRUCTION ACTIVITY SO AS NOT TO INTERFERE WITH THE ANY OFF SEASON STOCK WATER RUNS.
8. ALL BENDS SHALL BE MECHANICALLY RESTRAINED. SEE JOINT RESTRAINT TABLE, THIS SHEET.

REVISIONS	DATE	BY	DESIGNED	AE/DR
1	ADDENDUM 1	12/4/18	DR	
				AE/DR/LF
				CHECKED
				VALUE
				APPROVED
				VALUE

ONE INCH AT FULL SCALE. IF NOT, SCALE ACCORDINGLY.
 FILE NAME: BE-2509-005.3-C1.3-D100-IRR
 JOB No.
 DATE



Parametrix
 ENGINEERING, PLANNING, ENVIRONMENTAL SCIENCES
 150 NW PACIFIC PARK LANE, SUITE 110 | BEND, OR 97701
 P 541.508.7710
 WWW.PARAMETRIX.COM

PROJECT NAME
IRRIGATION IMPROVEMENTS

TYPICAL DETAILS
C1.3

DRAWING NO.
 4 OF 4
C1.3