

SPRING RIVER ROAD PARKING IMPROVEMENTS

DESCHUTES COUNTY ROAD DEPT. APRIL 2019

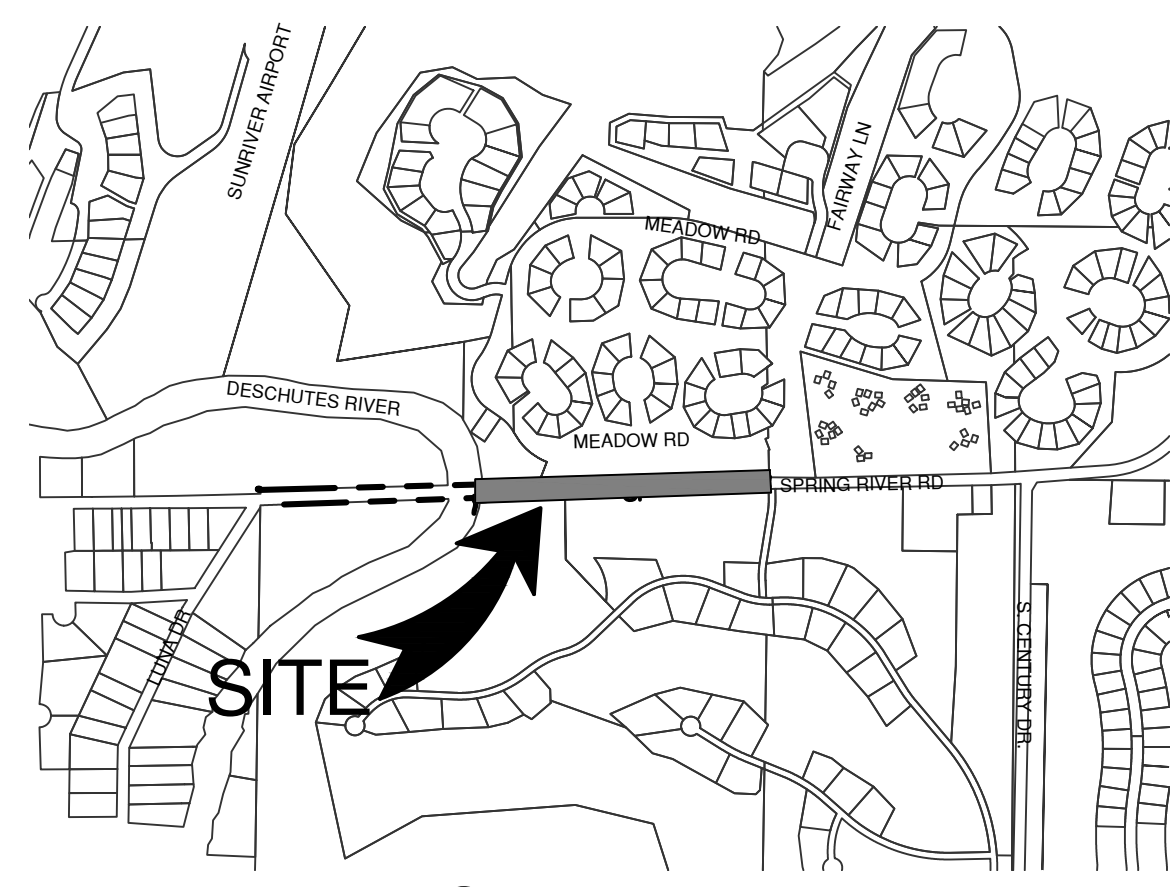

VICINITY MAP
SCALE: 1"=1000'

LEGEND

- | | |
|--|-----------------------------|
| | EDGE OF PAVEMENT |
| | PROPOSED STRIPING |
| | PROPOSED SAWCUT |
| | PROPOSED A/C DEMO |
| | ASPHALT PAVING |
| | CONTOUR LINE, 5' INTERVAL |
| | CONTOUR LINE, 1' INTERVAL |
| | PROPOSED SILT FENCE |
| | PROPOSED BIO-BAG PROTECTION |

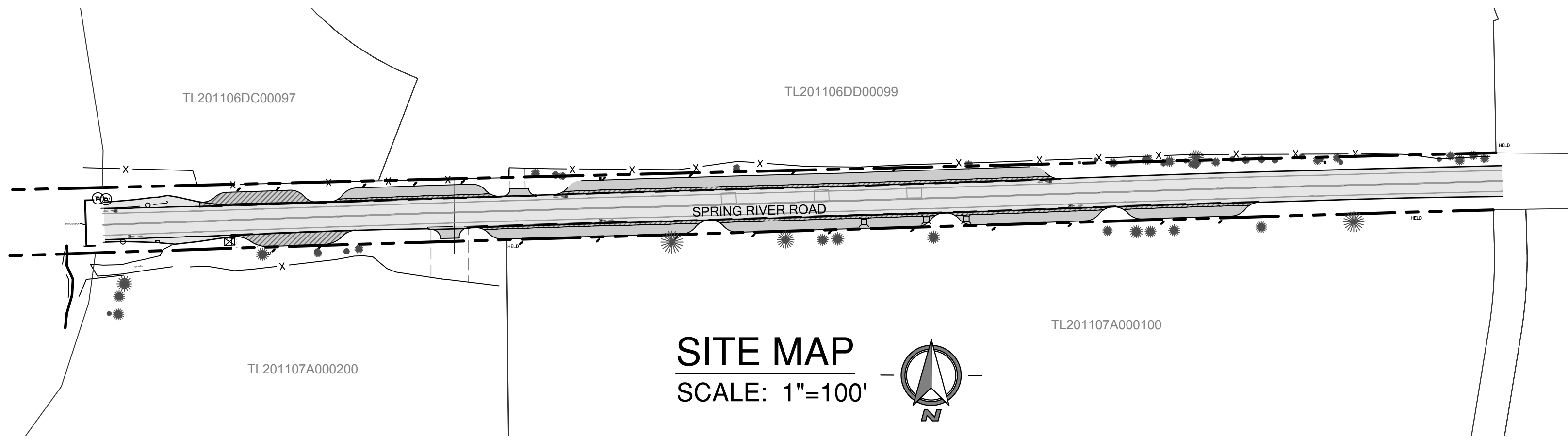

SITE MAP
SCALE: 1"=100'

GENERAL CONSTRUCTION NOTES

- NO CONSTRUCTION SHALL BE STARTED WITHOUT A NOTICE TO PROCEED BY THE DESCHUTES COUNTY ROAD DEPARTMENT. THE COUNTY ROAD DEPARTMENT AND THE DESIGN ENGINEER SHALL BE NOTIFIED AT LEAST TWO WORKING DAYS PRIOR TO THE START OF CONSTRUCTION. ANY CONSTRUCTION WORK DONE PRIOR TO NOTICE TO PROCEED BEING ISSUED OR WITHOUT INSPECTION WILL BE REJECTED.
- CONTRACTOR SHALL VERIFY ALL CONDITIONS ON THE JOB SITE INCLUDING BUT NOT LIMITED TO ALL DIMENSIONS, GRADES, ELEVATIONS, EXTENT AND COMPATIBILITY TO THE EXISTING SITE CONDITIONS, AND WITH THE WORK DESCRIBED ON THE ENGINEERS DRAWINGS. ANY DISCREPANCIES OR UNEXPECTED CONDITIONS THAT AFFECT OR CHANGE THE WORK DESCRIBED IN THE CONTRACT DOCUMENTS SHALL BE BROUGHT TO THE ENGINEERS ATTENTION IMMEDIATELY. CONTRACTOR SHALL NOT PROCEED WITH ANY OF THE WORK IN THE AREA OF DISCREPANCIES UNTIL ALL SUCH DISCREPANCIES ARE RESOLVED. IF THE CONTRACTOR CHOOSES TO DO SO, THEN IT IS UNDERSTOOD THAT THE CONTRACTOR IS CHOOSING TO PROCEED AT THE CONTRACTORS OWN RISK AND SHALL INCUR ALL COSTS, IF ANY TO RESOLVE THE ISSUES TO THE SATISFACTION OF THE ENGINEER.
- ALL ROADWAY CONSTRUCTION SHALL BE IN CONFORMANCE WITH DESCHUTES COUNTY STANDARDS (DCC TITLE 17, CHAPTER 48), AND THE CURRENT EDITION OF THE OREGON STANDARD SPECIFICATIONS FOR CONSTRUCTION.
- IT SHALL BE THE RESPONSIBILITY OF THE CONTRACTOR TO CONTACT 'UNDERGROUND LOCATE SERVICE' AT 1-800-332-2344 AT LEAST 48 BUSINESS DAY HOURS PRIOR TO THE START OF CONSTRUCTION FOR THE LOCATION OF POWER, GAS, CABLE TV AND TELEPHONE UNDERGROUND FACILITIES. THE CONTRACTOR WILL ALSO BE RESPONSIBLE FOR CONTACTING THE APPROPRIATE PUBLIC AGENCY FOR THE LOCATION OF UNDERGROUND FACILITIES.
- ALL UTILITIES SHOWN ARE ACCURATE TO THE EXTENT OF AVAILABLE RECORDS AND KNOWLEDGE. NO POTHOLING TO VERIFY LOCATIONS AND ELEVATIONS WAS AUTHORIZED BY THE OWNER. THE CONTRACTOR HAS THE TOTAL RESPONSIBILITY TO VERIFY THE LOCATION OF EXISTING UNDERGROUND UTILITIES AND TO NOTIFY THE UTILITY COMPANIES WHEN WORKING IN THEIR PROXIMITY. CONTRACTOR TO VERIFY LOCATION OF EXISTING UTILITIES PRIOR TO CONSTRUCTION. OREGON LAW REQUIRES YOU TO FOLLOW THE RULES ADOPTED BY THE OREGON UTILITY NOTIFICATION CENTER. THOSE RULES ARE SET FORTH IN OAR 952+001+0010 THROUGH 952+001+0090. YOU MAY OBTAIN COPIES OF THE RULES BY CALLING THE CENTER.
- CONTRACTOR SHALL TAKE ALL NECESSARY PRECAUTIONS TO PROTECT EXISTING UTILITIES AND IMPROVEMENTS
- ANY DAMAGE TO EXISTING FACILITIES OR IMPROVEMENTS, RESULTING FROM THE CONTRACTORS OPERATION, SHALL BE REPAIRED OR REPLACED AT CONTRACTORS EXPENSE
- DURING THE COURSE OF THE WORK, CONTRACTOR SHALL COORDINATE AND ACCOMMODATE OTHER CONTRACTORS OR OPERATIONS OF THE COUNTY
- ALL TRENCH BACKFILL OR EMBANKMENTS WITHIN PUBLIC RIGHT OF WAYS AND AREAS OUTSIDE OF PAVING SHALL BE CONSTRUCTED TO DESCHUTES COUNTY STANDARDS AND SPECIFICATIONS.
- CONTRACTOR SHALL RESTRICT ALL OPERATIONS TO AREAS WITHIN THE PROJECT BOUNDARIES. ANY DISRUPTION TO NATIVE LANDSCAPES OUTSIDE OF THE PROJECT AREA SHALL BE RESTORED AT NO COST TO THE OWNER
- THE CONTRACTOR SHALL FOLLOW ALL APPLICABLE INDUSTRIAL SAFETY REGULATIONS. DESCHUTES COUNTY AND THEIR OFFICIALS, THE ENGINEER, AND THE OWNER SHALL NOT BE RESPONSIBLE FOR ENFORCING SAFETY REGULATIONS
- MATERIAL QUANTITIES USED, NOTED, OR PROVIDED IN A SEPARATE ITEMIZED QUANTITY TAKE-OFF ARE AN ENGINEERS OPINION OF PROBABLY MATERIAL REQUIREMENTS, AND IS AN ESTIMATE ONLY. CONTRACTORS HAVE THE SOLE RESPONSIBILITY OF MAKING THEIR OWN QUANTITY TAKE-OFFS AND COST ESTIMATE
- BIDDERS SHALL BE PRE QUALIFIED WITH THE STATE OF OREGON IN ACCORDANCE WITH ORS 279C.430-279C.450 AND DESCHUTES COUNTY CODE 12.52.020
- COUNTY ROAD DEPARTMENTS SIGNATURE DOES NOT CONSTITUTE APPROVAL OF FACILITIES PROPOSED ON PRIVATE PROPERTY
- TEMPORARY ACCESS FOR ALL USERS SHALL BE MAINTAINED WITHIN THE EXISTING RIGHT OF WAY AND EASEMENTS

GENERAL EROSION CONTROL NOTES

- HOLD A PRE-CONSTRUCTION MEETING THAT INCLUDES THE INSPECTOR TO DISCUSS EROSION AND SEDIMENT CONTROL MEASURES AND CONSTRUCTION LIMITS.
- THE ESC PLAN MUST BE KEPT ONSITE AT ALL TIMES WHEN WORK IS OCCURRING.
- THE ESC MEASURES SHOWN ON THIS PLAN ARE MINIMUM REQUIREMENTS FOR ANTICIPATED SITE CONDITIONS. DURING THE CONSTRUCTION PERIOD, THE MEASURES MUST BE UPGRADED AS NEEDED TO COMPLY WITH ALL APPLICABLE LOCAL, STATE, AND FEDERAL EROSION AND SEDIMENT CONTROL REGULATIONS.
- INSPECT ALL ROADWAYS ADJACENT TO THE CONSTRUCTION ACCESS ROUTE AT THE END OF EACH DAY. SIGNIFICANT AMOUNTS OF SEDIMENT THAT LEAVES THE CONSTRUCTION SITE MUST BE CLEANED UP WITHIN 24-HRS AND STABILIZED BACK ON THE SITE OR PROPERLY DISPOSED. THE CAUSE OF SEDIMENT RELEASE MUST BE IDENTIFIED AND PREVENTED FROM CAUSING A RECURRENCE OF THE DISCHARGE WITHIN THE SAME 24-HRS. VACUUMING OR DRY SWEEPING MUST BE USED TO CLEAN-UP RELEASED SEDIMENT AND SEDIMENT MUST NOT BE INTENTIONALLY WASHED INTO STORM SEWERS, DRAINAGE WAYS, OR WATER BODIES.
- COVER AND SECURE ALL DUMP TRUCK LOADS LEAVING THE CONSTRUCTION SITE TO MINIMIZE SPILLAGE ON ROADS.
- RESTORE CONSTRUCTION ACCESS ROUTE EQUAL TO OR BETTER THAN THE PRE-CONSTRUCTION CONDITION.
- CONTROL FUGITIVE DUST FROM CONSTRUCTION ACTIVITY.
- STABILIZE EXPOSED UNWORKED SOILS (INCLUDING STOCKPILES), WHETHER AT FINAL GRADE OR NOT, WITHIN 10 CALENDAR DAYS DURING THE REGIONAL DRY SEASON (JULY 1 - SEPT. 30) AND WITHIN 5 CALENDAR DAYS DURING THE REGIONAL WET SEASON (OCT. 1 - JUNE 30).
- PROTECT INLETS, DRYWELLS, CATCH BASINS AND OTHER STORMWATER MANAGEMENT FACILITIES FROM SEDIMENT, WHETHER OR NOT THE FACILITIES ARE OPERABLE.
- LOCATE DESIGNATED VEHICLE AND EQUIPMENT SERVICE AREAS, FUEL, AND MATERIALS AWAY FROM DRAINAGE INLETS, WATERCOURSES, AND CANALS. PROPERLY CONTAIN AREAS USING BERMS, SANDBAGS, OR OTHER BARRIERS. REGULARLY INSPECT AND MAINTAIN EQUIPMENT, ESPECIALLY FOR DAMAGED HOSES AND LEAKY GASKETS.
- DESIGNATE AN AREA FOR CLEANING PAINTING EQUIPMENT AND TOOLS. NEVER CLEAN BRUSHES OR RINSE CONTAINERS INTO THE STREET, GUTTER, DRAINAGE INLET, OR WATERWAY.
- INSPECT ON A REGULAR BASIS (AT A MINIMUM WEEKLY, AND DAILY DURING/AFTER A RUNOFF PRODUCING STORM EVENT) AND MAINTAIN ALL EROSION AND SEDIMENT CONTROL BMPs TO ENSURE SUCCESSFUL PERFORMANCE OF THE BMPs.
- REMOVE TEMPORARY ESC BMPs WITHIN 30 DAYS AFTER THE TEMPORARY BMPs ARE NO LONGER NEEDED. PERMANENTLY STABILIZE AREAS THAT ARE DISTURBED DURING THE REMOVAL PROCESS.

GRADING NOTES

- ALL GRADING SHALL BE IN CONFORMANCE WITH THE CURRENT COUNTY STANDARDS
- SUBGRADE MATERIAL SHALL BE COMPACTED TO A RELATIVE COMPACTION OF 95% IN THE ZONE BETWEEN FINISHED SUBGRADE AND ONE FOOT BELOW. ALL MATERIAL IN FILL SECTIONS BELOW THE ZONE MENTIONED ABOVE SHALL BE COMPACTED TO 95% RELATIVE COMPACTION.
- EXCAVATORS SHALL COMPLY WITH THE PROVISIONS OF OAR 952-001-0090.
- ALL UNSUITABLE SOILS MATERIALS, RUBBISH, AND DEBRIS RESULTING FROM GRADING OPERATIONS SHALL BE REMOVED FROM THE JOB SITE AND DISPOSED OF PROPERLY.
- THE CONTRACTOR SHALL EMPLOY ALL LABOR, EQUIPMENT, AND METHODS REQUIRED TO PREVENT HIS OPERATIONS FROM PRODUCING DUST IN AMOUNTS DAMAGING TO PROPERTY, CULTIVATED VEGETATION, AND DOMESTIC ANIMALS OR CAUSING A NUISANCE TO PERSONS OCCUPYING BUILDINGS IN THE VICINITY OF THE JOB SITE. THE CONTRACTOR SHALL BE RESPONSIBLE FOR ANY DAMAGE CAUSED BY DUST RESULTING FROM HIS OPERATIONS.
- ALL FINAL CUT SLOPES SHALL NOT EXCEED A GRADE OF 2 TO 1 VERTICAL UNLESS OTHERWISE APPROVED. FILL SLOPES SHALL NOT EXCEED A GRADE OF 2 HORIZONTAL TO 1 VERTICAL UNLESS OTHERWISE APPROVED BY THE ENGINEER OR SHOWN ON THESE PLANS.

PERMANENT BENCH MARK USED

ID	DESCRIPTION	NORTHING	EASTING	ELEV
# 204	FND PROP COR 8" x 4" YPC CAP	314700.815	314708.949	4162.99
# 205	FND PROP COR 8" x 4" YPC CAP	3255755.291	3256021.813	4161.14

Utility Notification Center
Oregon Law Requires You To Follow Rules Adopted By The Oregon Utility Notification Center. Those Rules Are Set Forth In OAR 952-001-0010 Through OAR 952-001-0090. You May Obtain Copies Of The Rules By Calling The Center. (Note: The Telephone Number For The Oregon Utility Center Is (800) 332-2344.)

OWNER/DEVELOPER

DESCHUTES COUNTY ROAD DEPT.
61150 SE 27TH ST
BEND, OR 97702
P: (541) 388-6581

ENGINEER/SURVEYOR

HICKMAN WILLIAMS & ASSOCIATES.
62930 O.B. RILEY ROAD, BEND, OR 97703
P: (541) 389-9351

SHEET INDEX:

- C1.1 COVER SHEET
- C2.1 EXISTING CONDITIONS & DEMO
- C2.2 EXISTING CONDITIONS & DEMO
- C3.1 SITE PLAN & DETAILS
- C4.1 PLAN & PROFILE, STA 10+00-15+00
- C4.2 PLAN & PROFILE, STA 15+00-20+00
- C4.3 PLAN & PROFILE, STA 20+00-25+00

COPYRIGHT 2019
HWA, Inc.
Any reproduction or use in any form without express written consent of HICKMAN, WILLIAMS & ASSOCIATES INC. is unlawful and subject to criminal prosecution.
ALL RIGHTS RESERVED

**SPRING RIVER ROAD
PARKING IMPROVEMENTS**

COVER SHEET

DESCHUTES COUNTY

REVISIONS

1.	
2.	
3.	

DESIGNED BY: _____
DRAWN BY: **DWL**
CHECKED BY: **MPD**
SCALE: **AS SHOWN**
FILE: CD-180112-PP00.dwg

DATE: **04/18/2019**

SHEET

C1.1

HWA# 180112

Danl. S. Land Projects\180112 Des Co - Spring River Rd\dwg\CD-180112-PP00.dwg Thu Apr 18, 2019 - 11:10am

D:\S:\Land Projects\180112 Des Co - Spring River Rd\dwg\CD-180112-PP00.dwg Thu Apr 18, 2019 - 11:10am

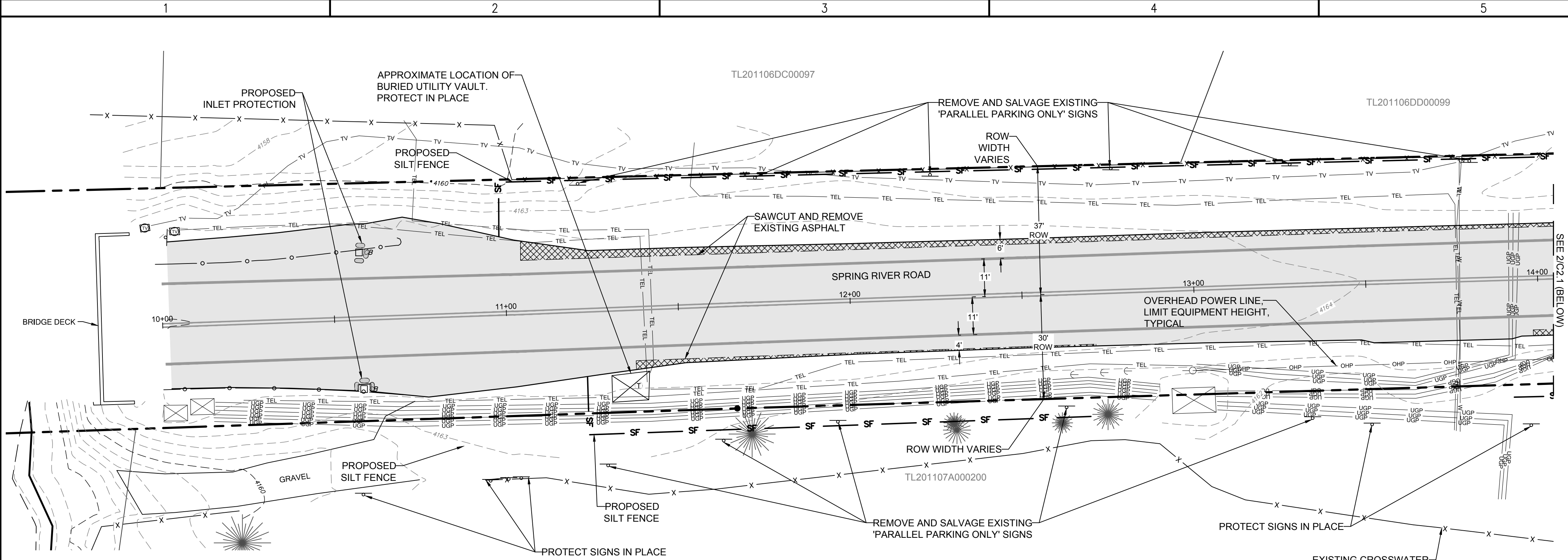

1 EXISTING CONDITIONS PLAN
C2.1 SCALE: 1" = 20'

- LEGEND**
- PROJECT BOUNDARY
 - ASSESSOR'S TAX LOT LINE (APPROXIMATE LOCATION)
 - CURB LINE
 - OHP OVERHEAD POWER
 - UGP UNDERGROUND POWER
 - CWP COMMON TRENCH - TV, PHONE, POWER
 - GAS UNDERGROUND GAS LINE
 - SS UNDERGROUND SEWER LINE
 - PS UNDERGROUND SEWER FORCE MAIN
 - SD UNDERGROUND STORM DRAIN
 - TEL UNDERGROUND TELEPHONE LINE
 - TV UNDERGROUND CABLE TV LINE
 - W UNDERGROUND WATER LINE
 - GB GRADE BREAK
 - X FENCE - WIRE
 - o FENCE - CHAIN LINK
 - o FENCE - WOOD
 - ASPHALT PAVING
 - CONCRETE
 - CB CATCH BASIN
 - ★ LIGHT
 - o GUY POLE/ANCHOR
 - o UTILITY POLE
 - o ELECTRIC TRANSFORMER & CONC. PAD
 - o ELECTRIC SERVICE
 - o CABLE TV SERVICE/RISER
 - o TELEPHONE RISER
 - o TELEPHONE MANHOLE
 - o ROAD SIGN
 - o MAILBOX
 - 3620 --- CONTOUR LINE, 1' INTERVAL
 - ★ LODGEPOLE PINE TREE, SIZE NOTED
- DEMO LEGEND**
- ★ TREE TO BE REMOVED
 - PROPOSED SAWCUT
 - EXISTING ASPHALT TO BE REMOVED

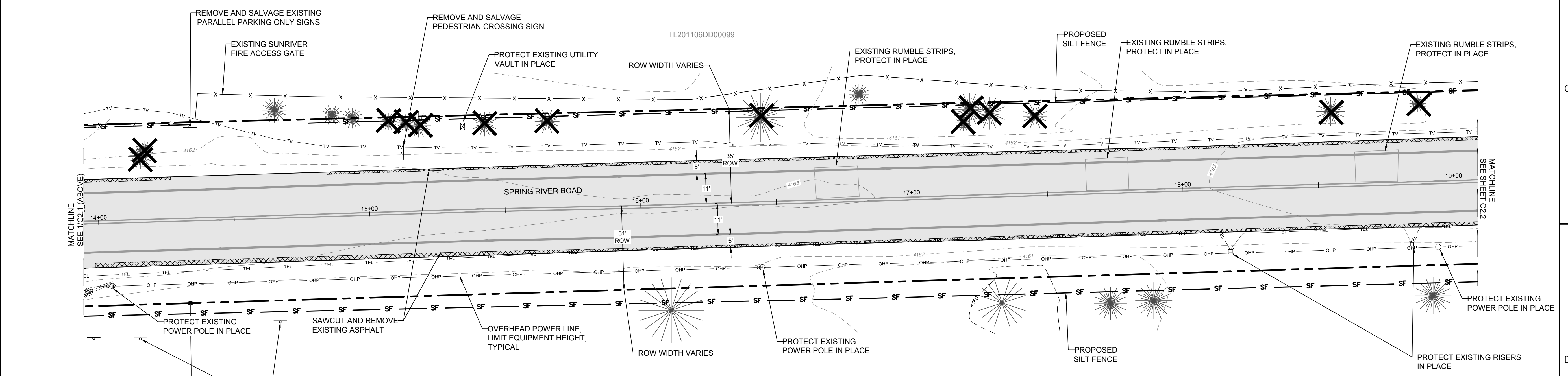

2 EXISTING CONDITIONS PLAN
C2.1 SCALE: 1" = 20'

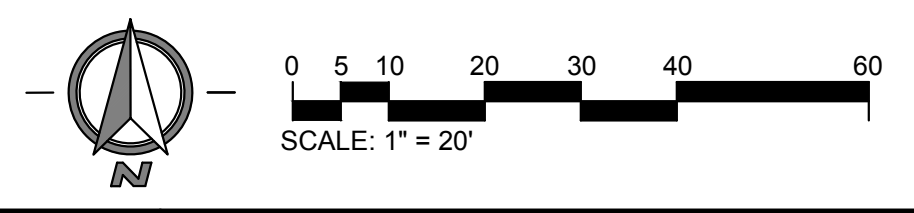

COPYRIGHT 2019
HWA, Inc.
Any reproduction or use in any form without express written consent of HICKMAN, WILLIAMS & ASSOCIATES INC. is unlawful and subject to criminal prosecution.
ALL RIGHTS RESERVED

REGISTERED PROFESSIONAL
ENGINEER
19360PE
Mark Douglas
OREGON
JUL. 22, 1991
MARK P. DOUGLAS

EXPIRES: 12/31/2019

**SPRING RIVER ROAD
PARKING IMPROVEMENTS
EXISTING CONDITIONS
& REMOVAL PLAN**

DESCHUTES COUNTY

HWA
CIVIL ENGINEERING | SURVEYING | PLANNING
6090 OS. SILEY ROAD, STE. 100, BEND, OR 97703
WEB: WWW.HWA-INC.COM

REVISIONS	
1.	
2.	
3.	

DESIGNED BY:
DRAWN BY: DWL
CHECKED BY: MPD
SCALE: AS SHOWN
FILE: CD-180112-PP00.dwg

DATE:
04/18/2019

SHEET
C2.1

HWA# 180112

Dani, S:\Land Projects\180112 Des Co - Spring River Rd\dwg\CD-180112-PP00.dwg Thu Apr 18, 2019 - 11:10am

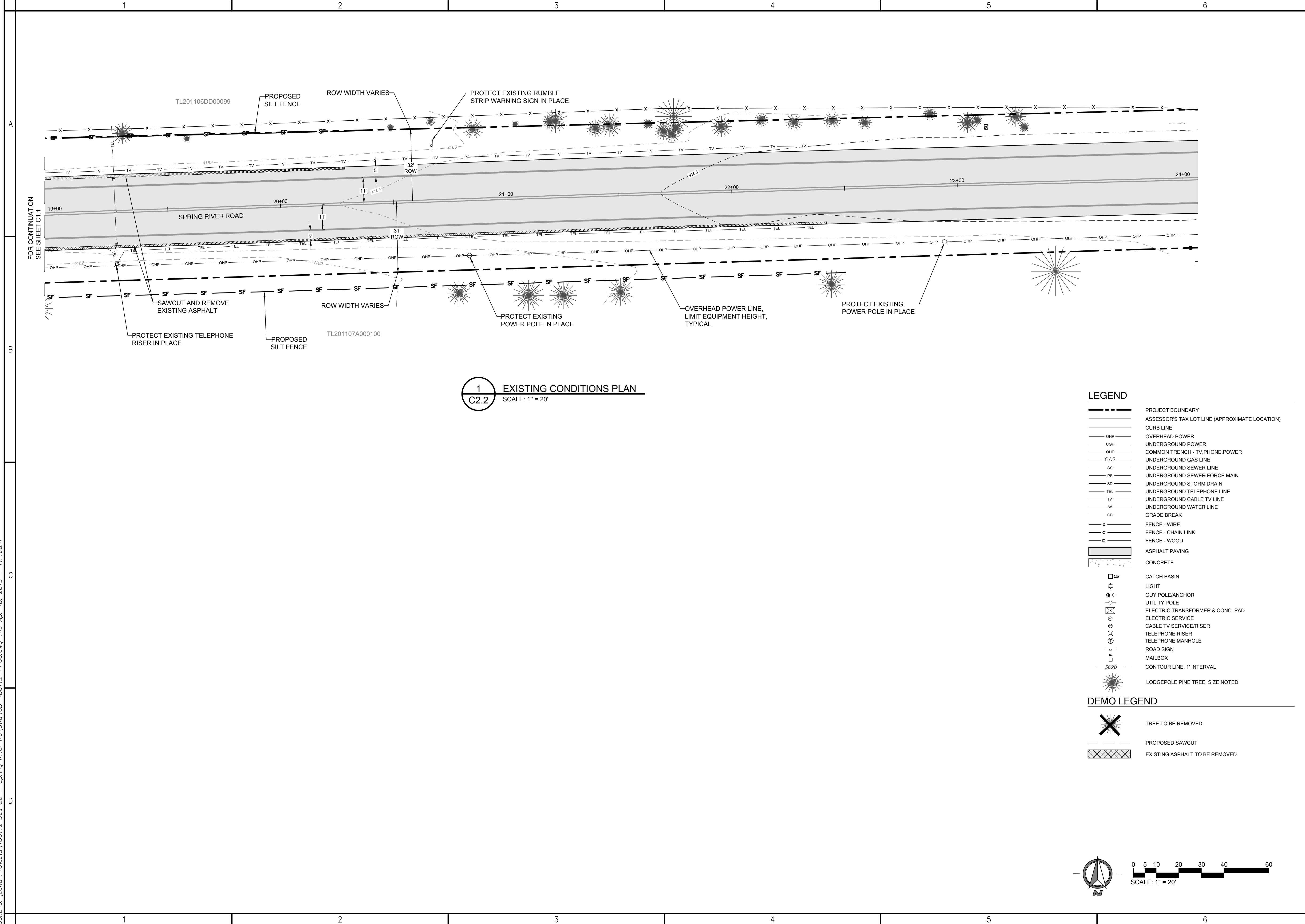

1 EXISTING CONDITIONS PLAN
C2.2 SCALE: 1" = 20'

- LEGEND**
- PROJECT BOUNDARY
 - - - ASSESSOR'S TAX LOT LINE (APPROXIMATE LOCATION)
 - ==== CURB LINE
 - OHP --- OVERHEAD POWER
 - UGP --- UNDERGROUND POWER
 - OHE --- COMMON TRENCH - TV,PHONE,POWER
 - GAS --- UNDERGROUND GAS LINE
 - SS --- UNDERGROUND SEWER LINE
 - PS --- UNDERGROUND SEWER FORCE MAIN
 - SD --- UNDERGROUND STORM DRAIN
 - TEL --- UNDERGROUND TELEPHONE LINE
 - TV --- UNDERGROUND CABLE TV LINE
 - W --- UNDERGROUND WATER LINE
 - GB --- GRADE BREAK
 - X FENCE - WIRE
 - o FENCE - CHAIN LINK
 - FENCE - WOOD
 - ASPHALT PAVING
 - CONCRETE
 - CB CATCH BASIN
 - ★ LIGHT
 - GUY POLE/ANCHOR
 - UTILITY POLE
 - ELECTRIC TRANSFORMER & CONC. PAD
 - ELECTRIC SERVICE
 - CABLE TV SERVICE/RISER
 - TELEPHONE RISER
 - TELEPHONE MANHOLE
 - ROAD SIGN
 - MAILBOX
 - 3620 --- CONTOUR LINE, 1' INTERVAL
 - ★ LODGEPOLE PINE TREE, SIZE NOTED

- DEMO LEGEND**
- ★ TREE TO BE REMOVED
 - PROPOSED SAWCUT
 - ▨ EXISTING ASPHALT TO BE REMOVED

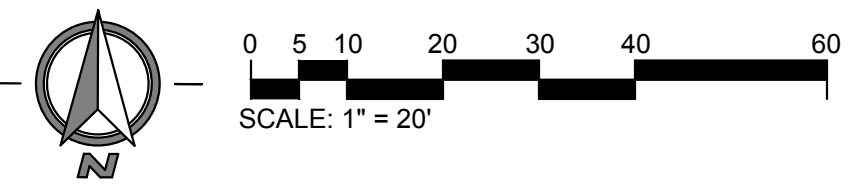

COPYRIGHT 2019
HWA, Inc.
Any reproduction or use in any form without express
written consent of HICKMAN, WILLIAMS & ASSOCIATES INC.
is unauthorized and subject to criminal prosecution.
ALL RIGHTS RESERVED



**SPRING RIVER ROAD
PARKING IMPROVEMENTS
EXISTING CONDITIONS
& REMOVAL PLAN**
DESCHUTES COUNTY



REVISIONS
1
2
3

DESIGNED BY: _____
DRAWN BY: DWL
CHECKED BY: MPD
SCALE: AS SHOWN
FILE: CD-180112-PP00.dwg

DATE: 04/18/2019

SHEET
C2.2
HWA# 180112

Dani, S. \Land Projects\180112 Des Co - Spring River Rd\dwg\CD-180112-PP00.dwg Thu Apr 18, 2019 - 11:10am

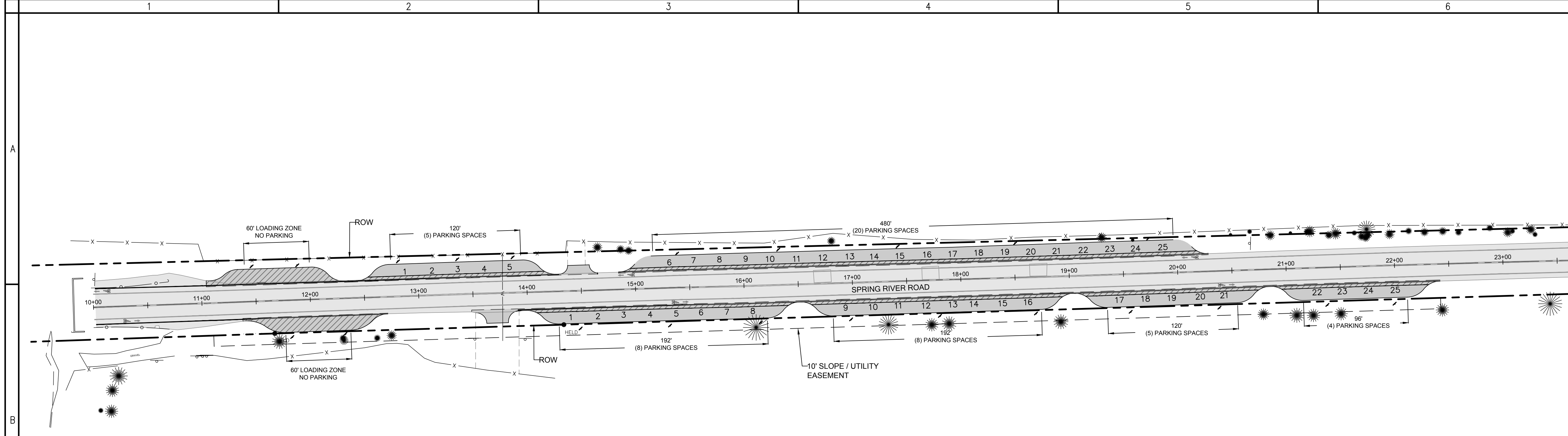

1
C3.1 SPRING RIVER RD PLAN, STA: 10+00 - 23+00
SCALE: 1" = 50'

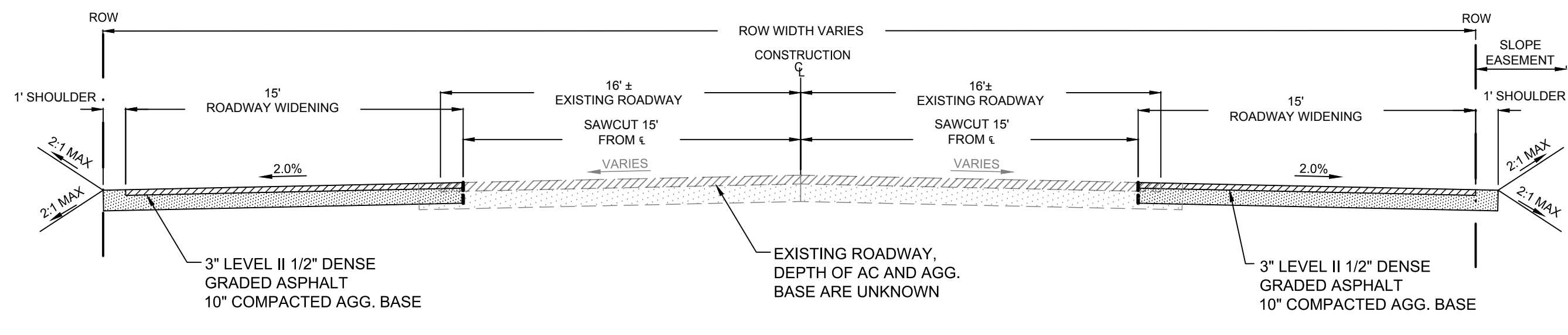
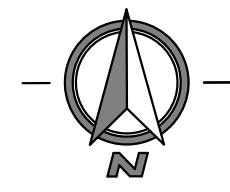

2
C3.1 ROADWAY WIDENING SECTION
N.T.S.

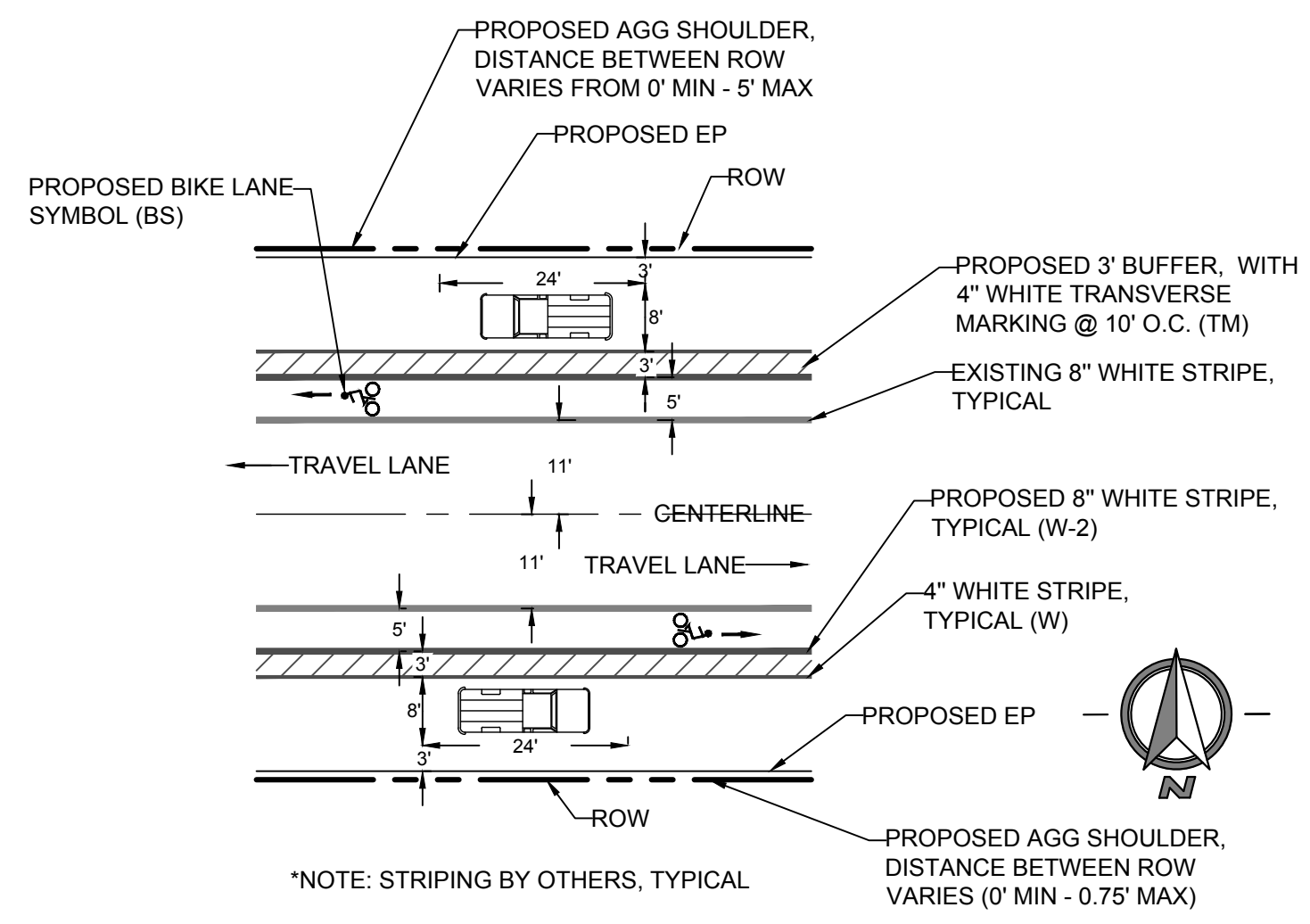

3
C3.1 ROADWAY WIDENING DETAIL
N.T.S.

COPYRIGHT 2019
HWA, Inc.
Any reproduction or use in any form without express
written consent of HICKMAN, WILLIAMS & ASSOCIATES INC.
is unlawful and subject to criminal prosecution.
ALL RIGHTS RESERVED



SPRING RIVER ROAD
PARKING IMPROVEMENTS
OVERALL SITE PLAN
& DETAILS
DESCHUTES COUNTY



REVISIONS	
1.	
2.	
3.	

DESIGNED BY: _____
DRAWN BY: DWL
CHECKED BY: MPD
SCALE: AS SHOWN
FILE: CD-180112-PP00.dwg

DATE:
04/18/2019

SHEET
C3.1

HWA# 180112

- CONSTRUCTION NOTES:**
- CONTRACTOR TO POT HOLE EXISTING UTILITIES TO VERIFY DEPTH AND LOCATION. CONTRACTOR TO CONTACT ENGINEER IF THERE ARE ANY DISCREPANCIES
 - ALL STRIPING AND SIGN INSTALLATION ARE TO BE PERFORMED BY OTHERS. ALL SIGNS ARE TO BE INSTALLED ON PERFORATED STEEL SQUARE TUBE (PSST) SIGN SUPPORTS WITH ANCHOR FOUNDATIONS PER ODOT STD DWG'S TM681 & TM687.
 - SEE ROADWAY SECTION DETAIL 2/C3.1 AND ROADWAY WIDENING DETAIL 3/C3.1 FOR DIMENSIONING

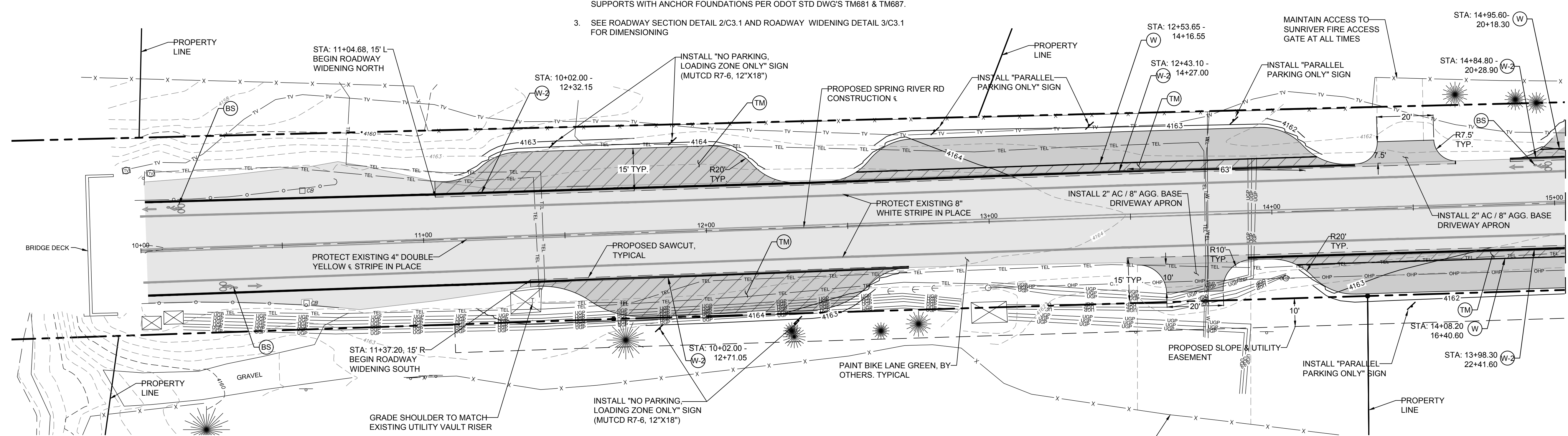

- STRIPING LEGEND (STRIPING BY OTHERS, TYP.)**
- (W) INSTALL 4" WHITE STRIPE PER ODOT STD DWG TM500
 - (W-2) INSTALL 8" WHITE STRIPE PER ODOT STD DWG TM500
 - (BS) INSTALL WHITE BIKE LANE STANDARD STENCIL PER ODOT STD DWG TM 503
 - (TM) INSTALL MODIFIED TRANSVERSE MARKINGS. 4" WHITE STRIPE'S AT A 36° ANGLE WITH 10' SPACING.

SPRING RIVER RD PLAN, STA 10+00 TO 15+00
SCALE: 1" = 20'

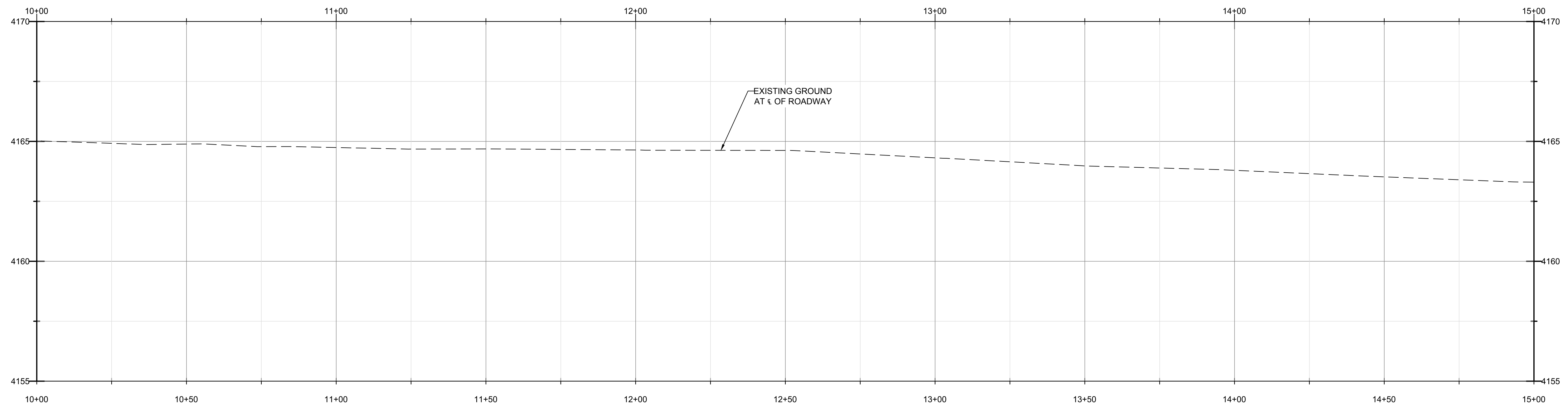
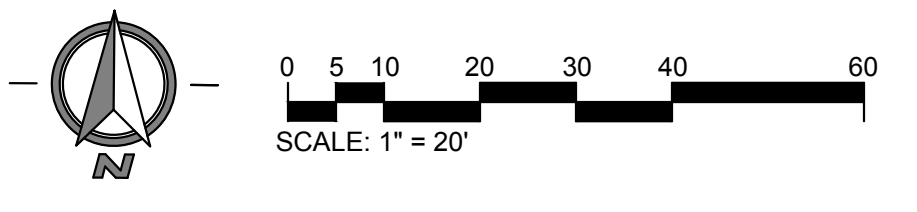

SPRING RIVER RD PROFILE, STA 10+00 TO 15+00
SCALE: HORIZONTAL 1" = 20' / VERTICAL 1" = 10'

COPYRIGHT 2019
HWA, Inc.
Any reproduction or use in any form without express written consent of HICKMAN, WILLIAMS & ASSOCIATES INC. is prohibited and subject to criminal prosecution.
ALL RIGHTS RESERVED

**SPRING RIVER ROAD
PARKING IMPROVEMENTS**

PLAN & PROFILE

STA: 10+00 - 15+00

DESCHUTES COUNTY

HWA

CIVIL ENGINEERING | SURVEYING | PLANNING

6090 OSB BILEY ROAD, STE 100, BEND, OR 97703
WEB: WWW.HWA-INC.ORG

REVISIONS	
1.	
2.	
3.	

DESIGNED BY: _____
DRAWN BY: DWL
CHECKED BY: MPD
SCALE: AS SHOWN
FILE: CD-180112-PP00.dwg

DATE: 04/18/2019

SHEET

C4.1

HWA# 180112

D:\S:\Land Projects\180112 Des Co - Spring River Rd\dwg\CD-180112-PP00.dwg Thu Apr 18, 2019 - 11:10am

DanL S:\Land Projects\180112 Des Co - Spring River Rd\dwg\CD-180112-PP00.dwg Thu Apr 18, 2019 - 11:10am

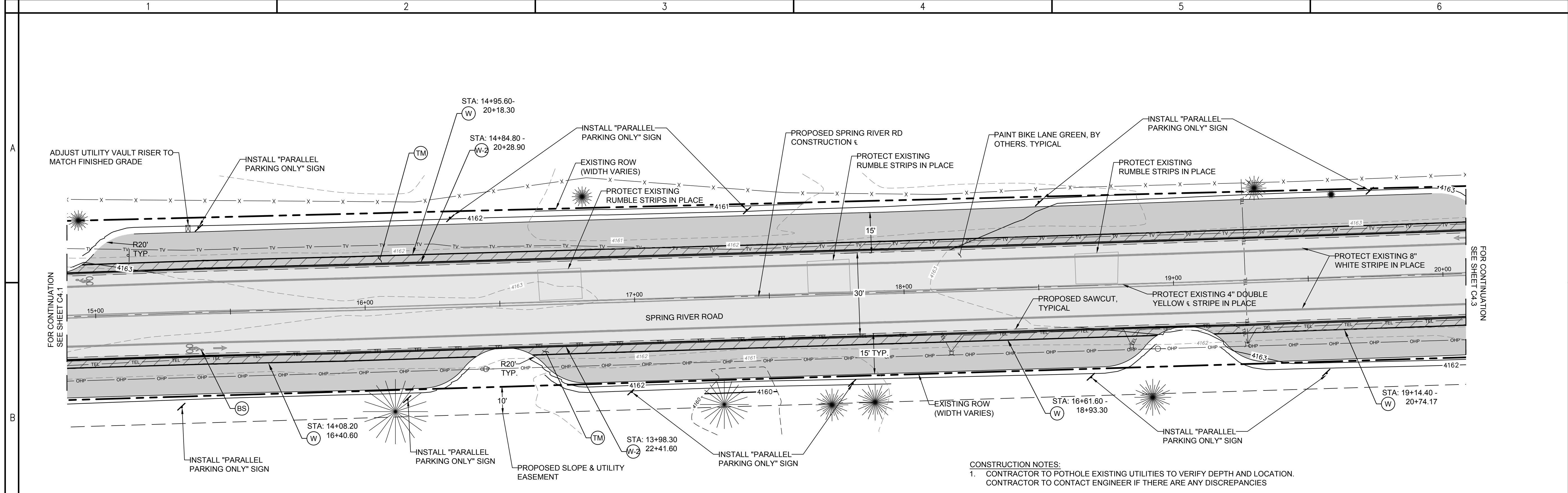

- STRIPING LEGEND (STRIPING BY OTHERS, TYP.)**
- (W) INSTALL 4" WHITE STRIPE PER ODOT STD DWG TM500
 - (W-2) INSTALL 8" WHITE STRIPE PER ODOT STD DWG TM500
 - (BS) INSTALL WHITE BIKE LANE STANDARD STENCIL PER ODOT STD DWG TM 503
 - (TM) INSTALL MODIFIED TRANSVERSE MARKINGS. 4" WHITE STRIPE'S AT A 36° ANGLE WITH 10' SPACING.

SPRING RIVER RD PLAN, STA 15+00 TO 20+00
SCALE: 1" = 20'

- CONSTRUCTION NOTES:**
- CONTRACTOR TO POTHOLE EXISTING UTILITIES TO VERIFY DEPTH AND LOCATION. CONTRACTOR TO CONTACT ENGINEER IF THERE ARE ANY DISCREPANCIES
 - ALL STRIPING AND SIGN INSTALLATION ARE TO BE PERFORMED BY OTHERS. ALL SIGNS ARE TO BE INSTALLED ON PERFORATED STEEL SQUARE TUBE (PSST) SIGN SUPPORTS WITH ANCHOR FOUNDATIONS PER ODOT STD DWG'S TM681 & TM687.
 - SEE ROADWAY SECTION DETAIL 2/C3.1 AND ROADWAY WIDENING DETAIL 3/C3.1 FOR DIMENSIONING

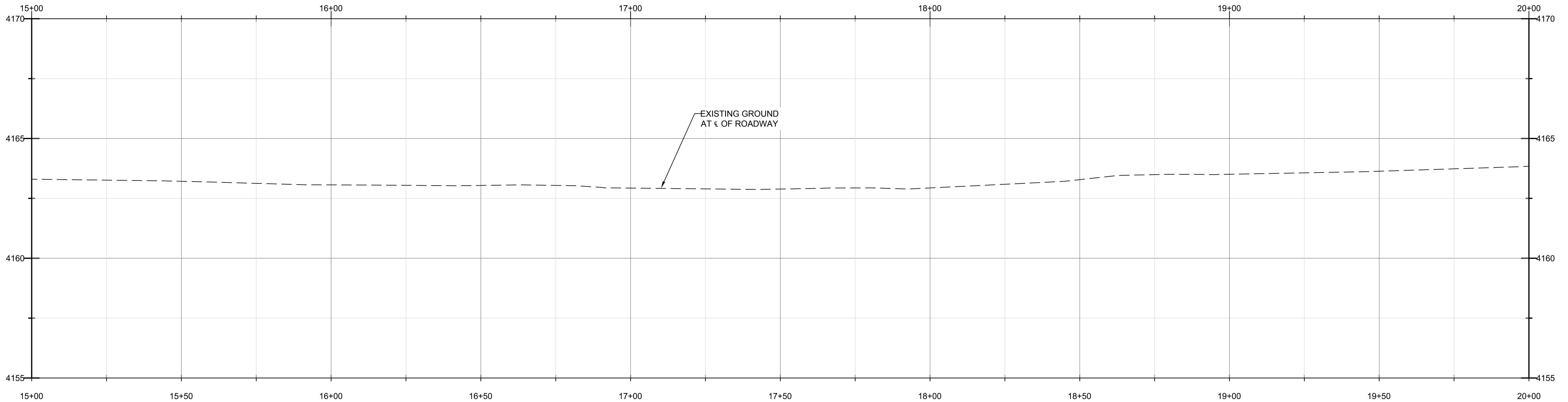
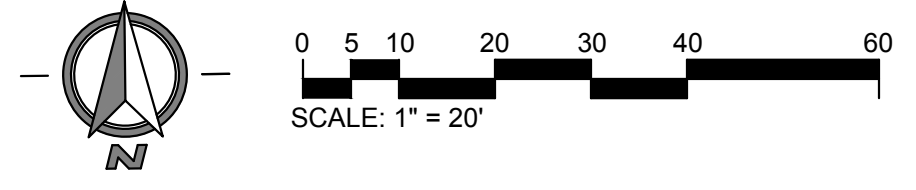

SPRING RIVER RD PROFILE, STA 15+00 TO 20+00
SCALE: HORIZONTAL 1" = 20' / VERTICAL 1" = 10'

COPYRIGHT 2019
HWA, Inc.
Any reproduction or use in any form without express written consent of HICKMAN, WILLIAMS & ASSOCIATES INC. is unlawful and subject to criminal prosecution.
ALL RIGHTS RESERVED

**SPRING RIVER ROAD
PARKING IMPROVEMENTS
PLAN & PROFILE
STA: 15+00 - 20+00**
DESCHUTES COUNTY

HWA
CIVIL ENGINEERING | SURVEYING | PLANNING
6090 OS. BILEY ROAD, STE. 100, BEND, OR 97703
WEB: WWW.HWA-INC.ORG

REVISIONS	
1.	
2.	
3.	

DESIGNED BY: _____
DRAWN BY: DWL
CHECKED BY: MPD
SCALE: AS SHOWN
FILE: CD-180112-PP00.dwg

DATE: 04/18/2019

SHEET
C4.2
HWA# 180112

D:\s1\Land Projects\180112 Des Co - Spring River Rd\dwg\CD-180112-PP00.dwg Thu Apr 18, 2019 - 11:10am

COPYRIGHT 2019
HWA, Inc.
Any reproduction or use in any form without express
written consent of HICKMAN, WILLIAMS & ASSOCIATES INC.
is unlawful and subject to criminal prosecution.
ALL RIGHTS RESERVED



**SPRING RIVER ROAD
PARKING IMPROVEMENTS
PLAN & PROFILE**
STA: 20+00 - 25+00
DESCHUTES COUNTY



REVISIONS	
1.	
2.	
3.	

DESIGNED BY: _____
DRAWN BY: DWL
CHECKED BY: MPD
SCALE: AS SHOWN
FILE: CD-180112-PP00.dwg

DATE: 04/18/2019

SHEET
C4.3
HWA# 180112

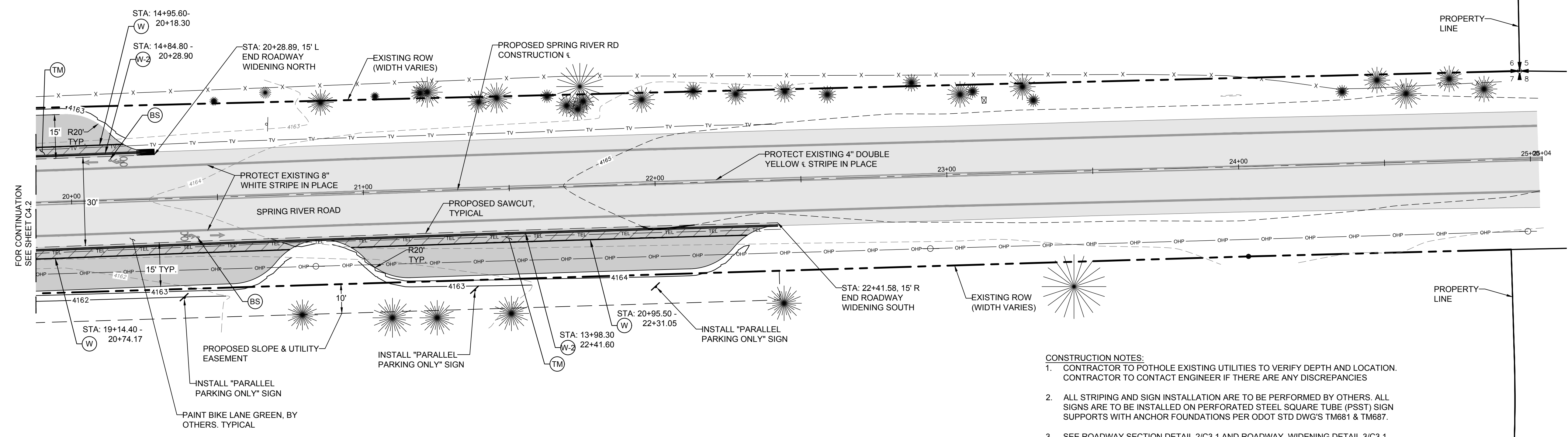

- CONSTRUCTION NOTES:**
- CONTRACTOR TO POTHOLE EXISTING UTILITIES TO VERIFY DEPTH AND LOCATION. CONTRACTOR TO CONTACT ENGINEER IF THERE ARE ANY DISCREPANCIES
 - ALL STRIPING AND SIGN INSTALLATION ARE TO BE PERFORMED BY OTHERS. ALL SIGNS ARE TO BE INSTALLED ON PERFORATED STEEL SQUARE TUBE (PSST) SIGN SUPPORTS WITH ANCHOR FOUNDATIONS PER ODOT STD DWG'S TM681 & TM687.
 - SEE ROADWAY SECTION DETAIL 2/C3.1 AND ROADWAY WIDENING DETAIL 3/C3.1 FOR DIMENSIONING

SPRING RIVER RD PLAN, STA 20+00 TO 25+00
SCALE: 1" = 20'

- STRIPING LEGEND (STRIPING BY OTHERS, TYP.)**
- (W) INSTALL 4" WHITE STRIPE PER ODOT STD DWG TM500
 - (W-2) INSTALL 8" WHITE STRIPE PER ODOT STD DWG TM500
 - (BS) INSTALL WHITE BIKE LANE STANDARD STENCIL PER ODOT STD DWG TM 503
 - (TM) INSTALL MODIFIED TRANSVERSE MARKINGS. 4" WHITE STRIPE'S AT A 36° ANGLE WITH 10' SPACING.

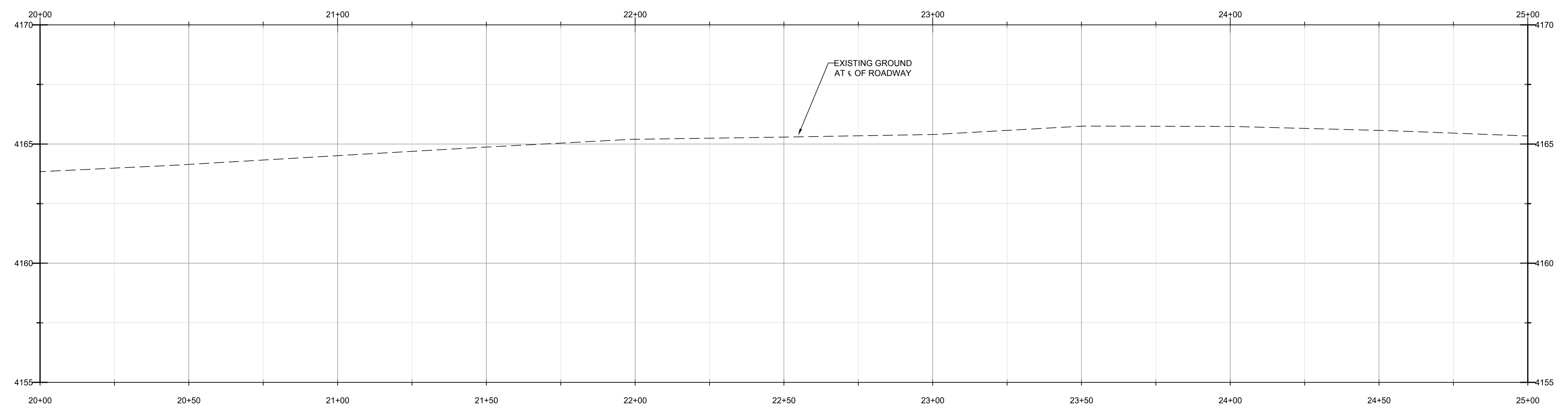
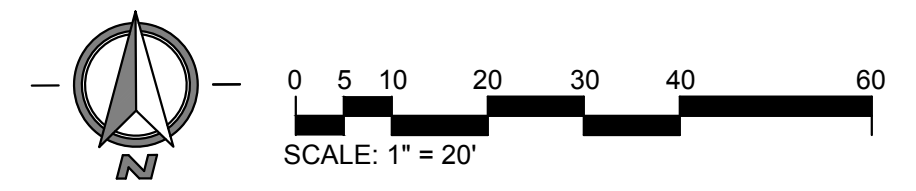

SPRING RIVER RD PROFILE, STA 20+00 TO 25+00
SCALE: HORIZONTAL 1" = 20' / VERTICAL 1" = 10'