



ADDENDUM NO. 1

TUMALO RD / TUMALO PL INTERSECTION IMPROVEMENT

The Bidding Documents for the Tumalo Rd / Tumalo PI Intersection Improvement project are amended as follows:

SPECIAL PROVISIONS

Add the following:

00744.40 Season and Temperature Limitations – Replace this subsection, except for the subsection number and title, with the following:

Place ACP when the temperature of the surface that is to be paved is not less than the temperature indicated:

Nominal Compacted Thickness of Individual Lifts and Courses as shown on the Typical Section of the Plans	All Levels	Level 1 and Level 2	Level 3	
		All Courses	Travel Lane Wearing Course	All Other Courses
	Surface Temperature*	From To Inclusive	From To Inclusive	From To Inclusive
Less than 2 inches	60 °F	All Year**	All Year**	All Year**
2 inches - 2 1/2 inches	50 °F	All Year**	All Year**	All Year**
Greater than 2 1/2 inches	40 °F	All Year**	All Year**	All Year**
Temporary	40 °F	All Year**	All Year**	All Year**

* Do not use field burners or other devices to heat the Pavement surface to the specified minimum temperature.

** If placing ACP between March 15 and September 30, temperature requirement may be lowered 5 °F.

BIDDING PLANS

Replace Sheets C2.0, C2.1, C3.0, C7.0, and C7.2 in the Bidding Plans with the attached Sheets C2.0, C2.1, C3.0, C7.0, and C7.2.

The Bidding Documents for the Tumalo Rd / Tumalo PI Intersection Improvement project are amended as described above.

Cody Smith, PE
County Engineer

September 22, 2020
Date

I acknowledge receipt of Addendum Number 1.

SIGNATURE OF BIDDER

Date

THIS ADDENDUM, EXCLUDING ATTACHMENTS, SHALL BE SIGNED AND SUBMITTED WITH THE BID PROPOSAL BY THE BIDDER.

PLOTTED BY: rickoddy DATE: Tuesday, September 22, 2020 9:19:40 AM
 PATH: U:\Bentley\Projects\Clients\2509-Deschutes County\297-2509-005 OBRH Design Phase\985Ves\CADD\DWG\TUMALO RD\BAs\CD\TUMALO RD\TUMALO RD-TUMALO PL
 LAYOUT: C2.0 TYPICAL SECTIONS

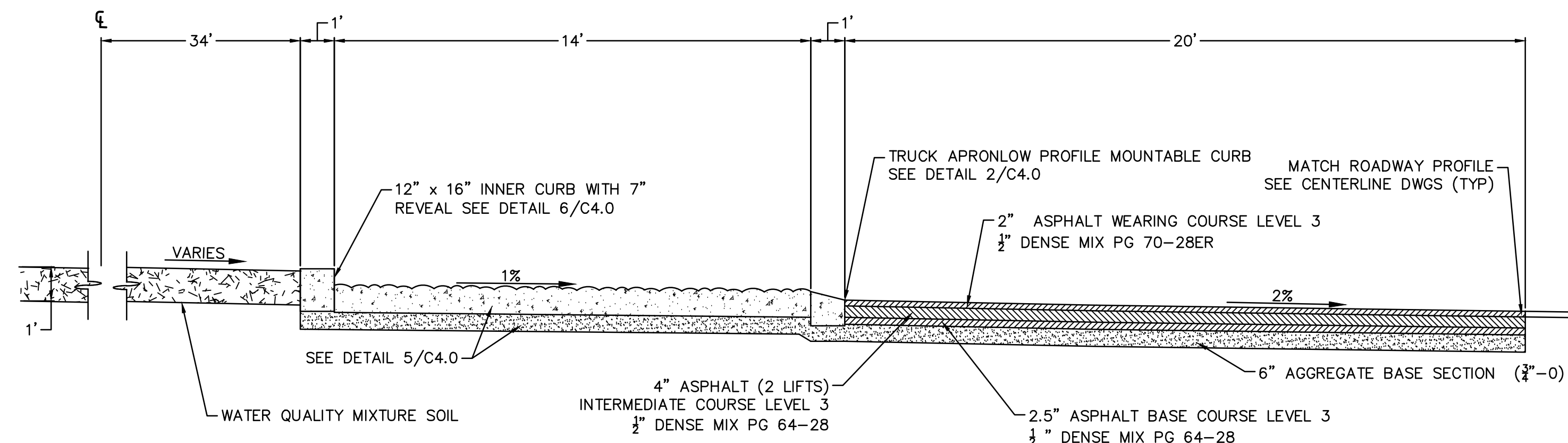

INNER ROUNDABOUT SECTION
 STA: 0+00-3+14.5
 N.T.S. 1
 C2.0

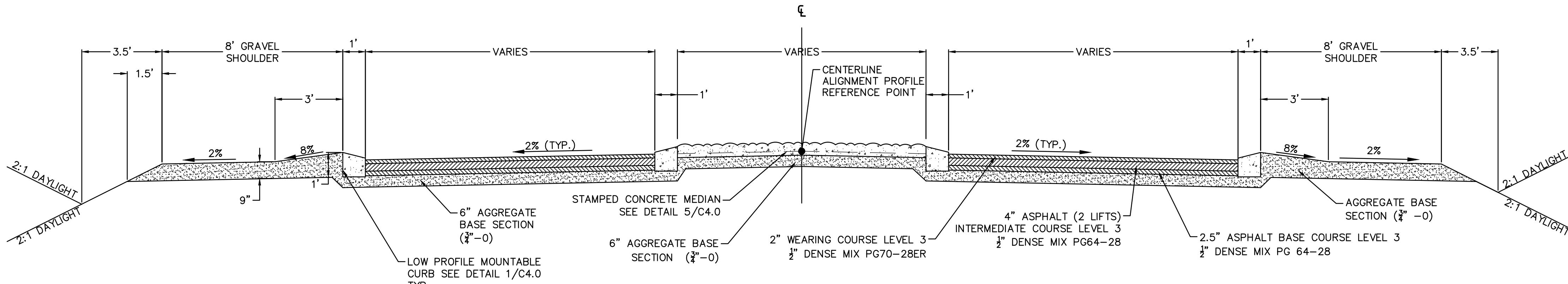

ROADWAY PERPETUAL SECTION
 TUMALO RD STA: 393+41.3-394+43.3 STA:395+82.5-396+84.2
 TUMALO PL STA: 8+25.4-9+30.1
 N.T.S. 2
 C2.0

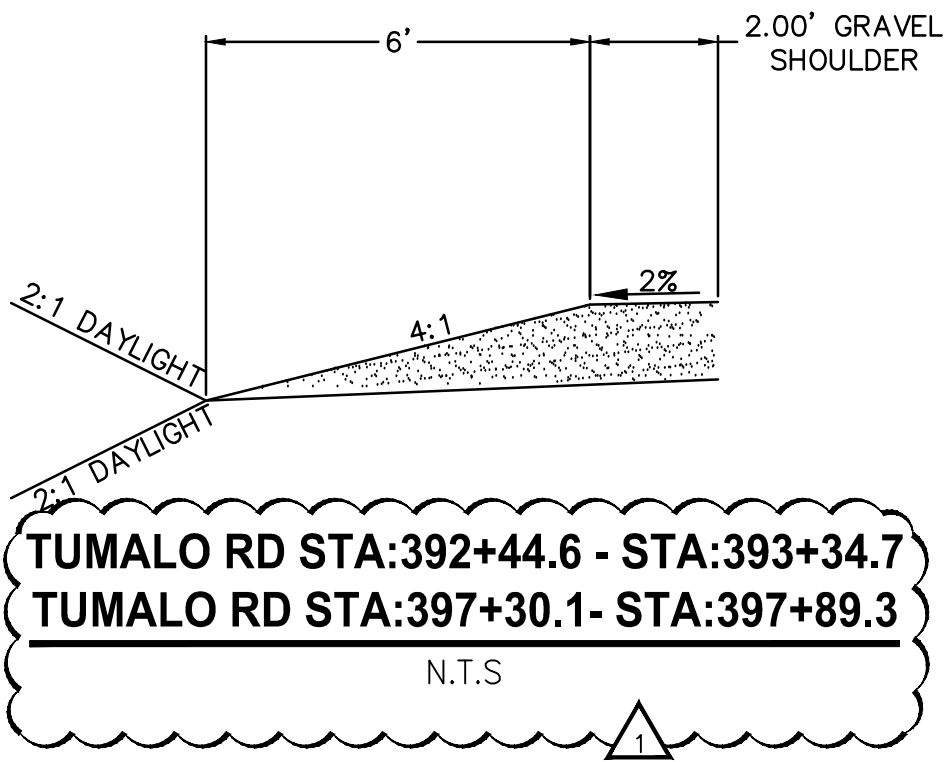

TUMALO RD STA:392+44.6 - STA:393+34.7
TUMALO RD STA:397+30.1- STA:397+89.3
 N.T.S. 1

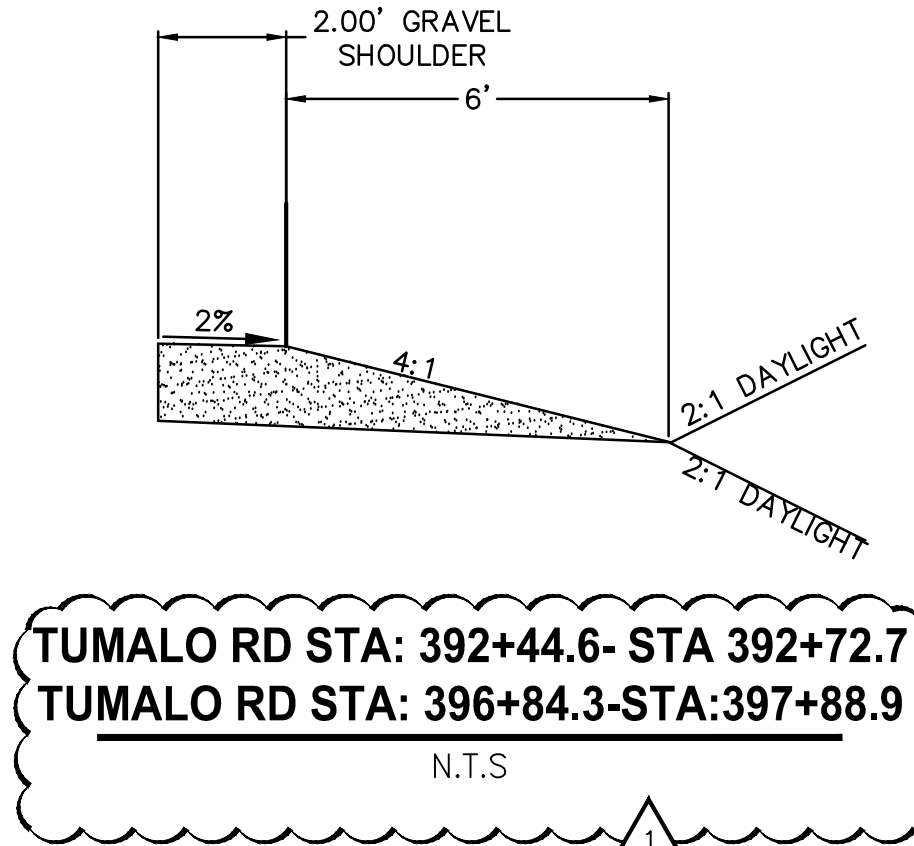
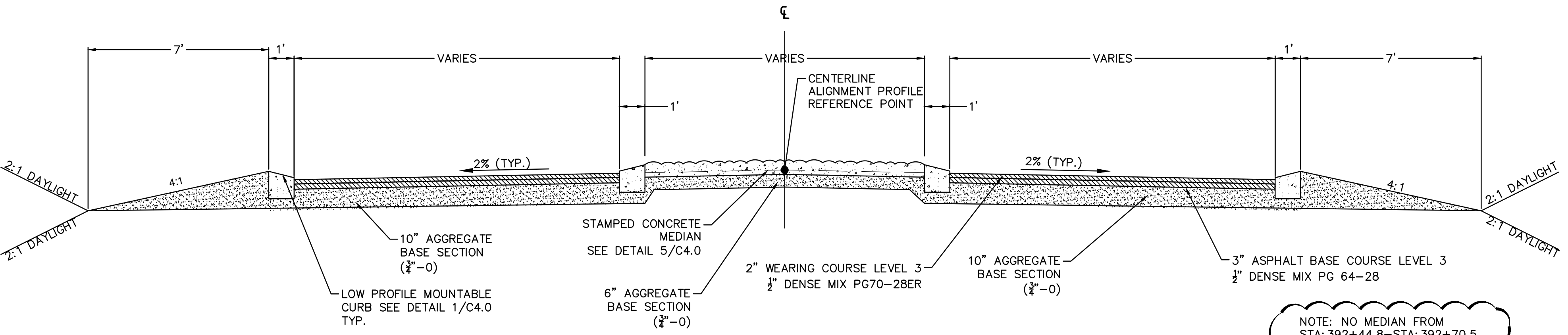

TUMALO RD STA: 392+44.6- STA 392+72.7
TUMALO RD STA: 396+84.3-STA:397+88.9
 N.T.S. 1

NOTE: NO MEDIAN FROM STA: 392+44.8-STA: 392+70.5

ROADWAY WITH MEDIAN & VARYING CURB
 TUMALO RD STA: 392+44.6-393+41.3 STA:396+84.2-397+89.1
 N.T.S. 3
 C2.0

REVISIONS	DATE	BY	DESIGNED
1	9/22/20	DR	
TYPICAL SECTION STATIONING			

ONE INCH AT FULL SCALE. IF NOT, SCALE ACCORDINGLY.
 FILE NAME: BE2509005-C2.0-TS00
 JOB No.: 297-2509-005
 DATE: 05/2020



PROJECT NAME
TUMALO RD / TUMALO PL INTERSECTION IMPROVEMENTS

TYPICAL SECTIONS

DRAWING NO.
 3 OF 40
C2.0

PLOTTED BY: rickov DATE: Tuesday, September 22, 2020 9:18:30 AM
 PATH: \\parametrix.com\pmx\Bent\Projects\Clients\2509-deschutes_county\297-2509-005_ebrh_design_phase\99\Views\CADD\DWG\tumalo rd -tumalo pl
 LAYOUT: C2.1 TYPICAL SECTIONS

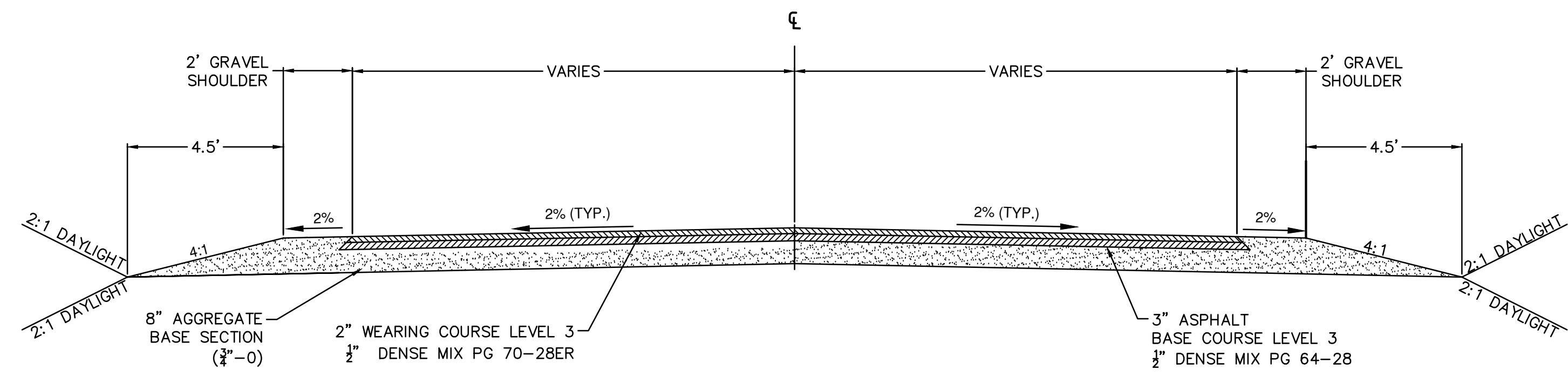

ROADWAY NO MEDIAN/CURB
SCHOOL ACCESS STA: 10+69.9-14+10
78TH STREET STA: 6+00-6+55
 N.T.S. 1
C2.1

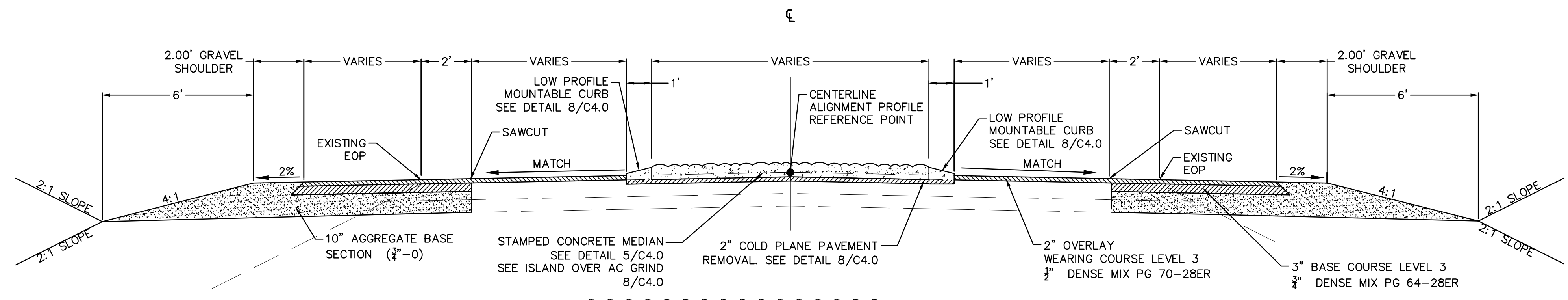

WIDENING SECTION
TUMALO PL STA: 4+30.4-STA: 8+25.4
TUMALO RD STA: 387+31.2-392+44.8
 N.T.S. 2
C2.1

NOTE: NO MEDIAN FROM
 TUMALO PL STA: 4+30.4-STA: 7+18.5
 TUMALO RD STA: 387+31.2-STA: 382+44.8

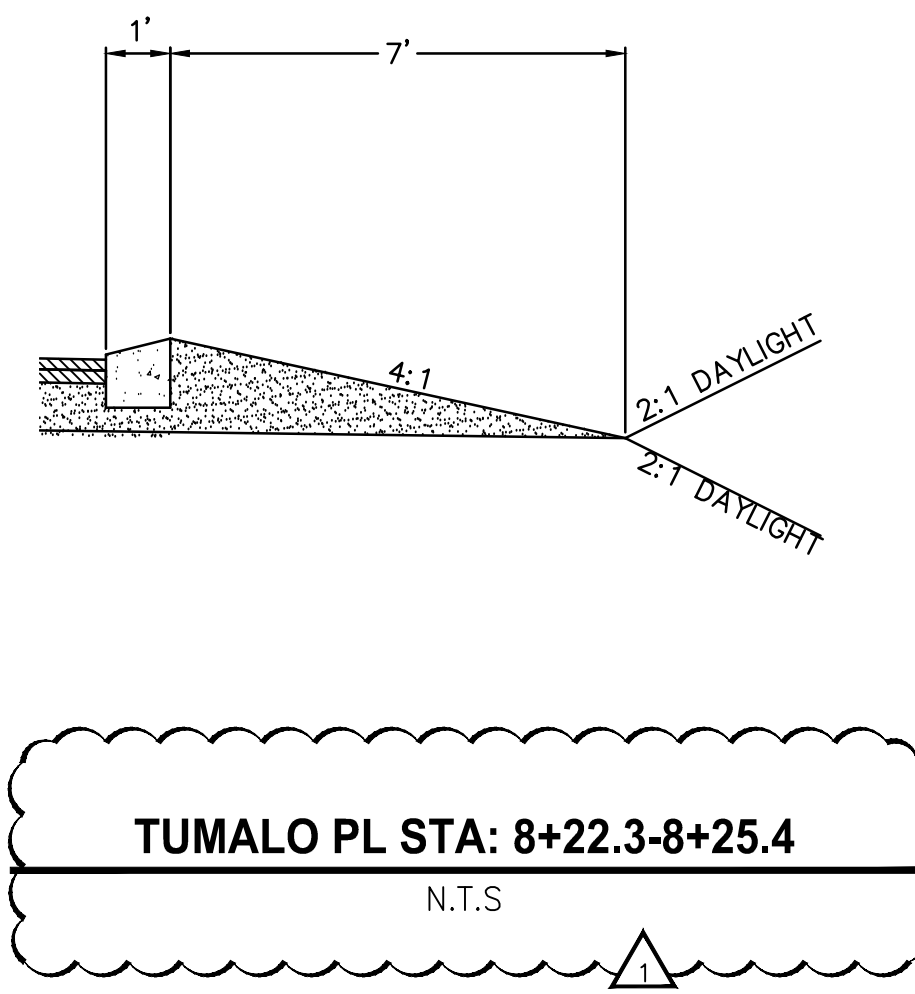

TUMALO PL STA: 8+22.3-8+25.4
 N.T.S. 1

REVISIONS	DATE	BY	DESIGNED
1	9/22/20	DR	
TYPICAL SECTION STATIONING			

ONE INCH AT FULL SCALE.
 IF NOT, SCALE ACCORDINGLY

FILE NAME
 BE2509005-C2.1-TS00

JOB No.
 297-2509-005

DATE
 05/2020

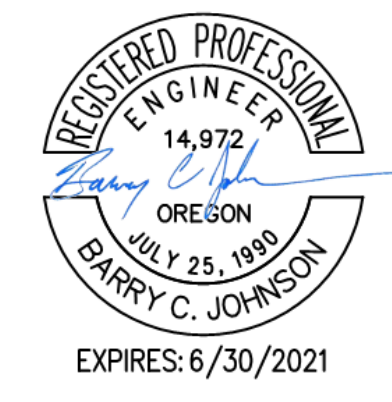



PROJECT NAME
**TUMALO RD / TUMALO PL
 INTERSECTION IMPROVEMENTS**

TYPICAL SECTIONS

DRAWING NO.
 4 OF 40
C2.1

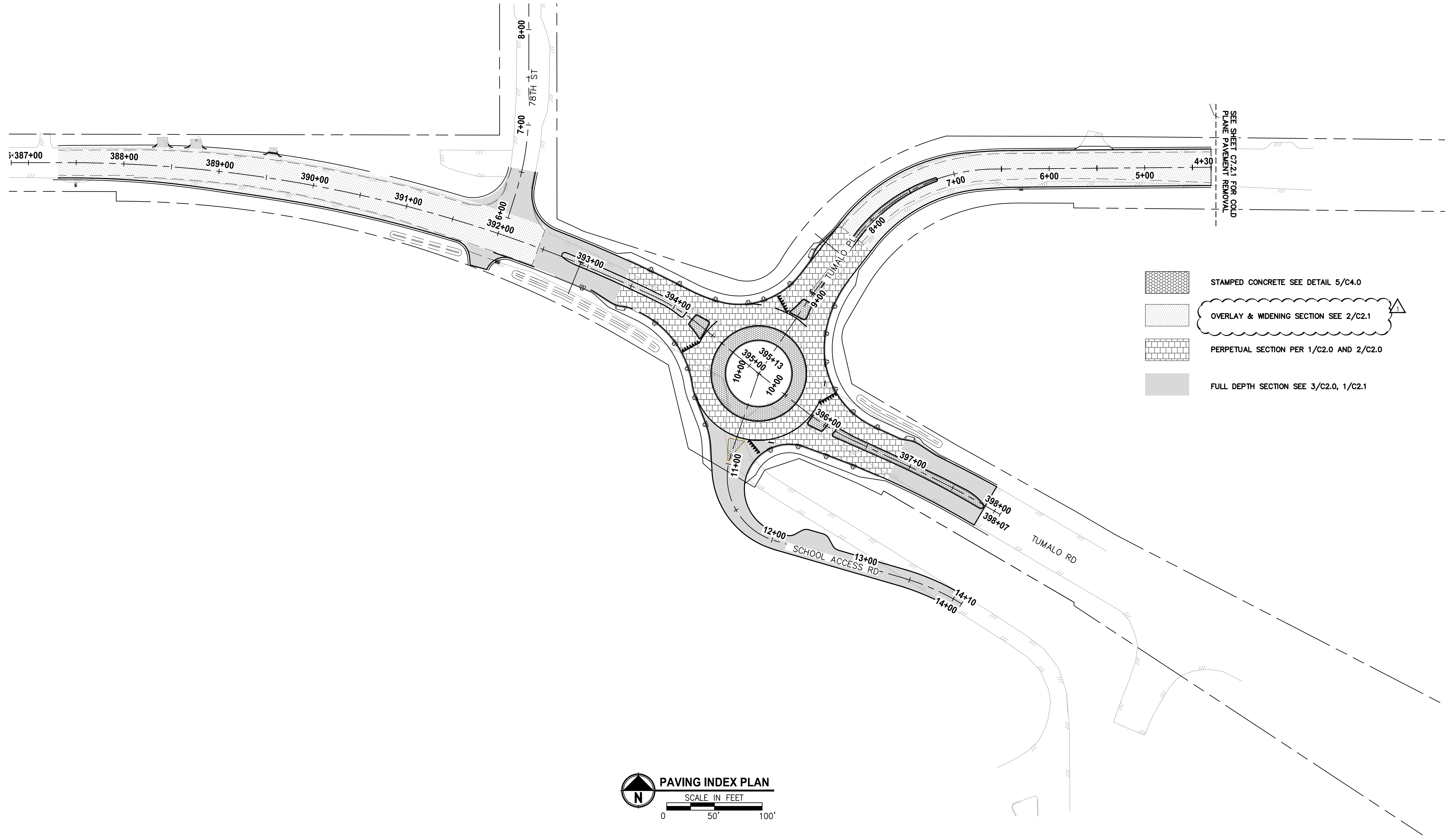
LAYOUT: C3.0 - PAVING INDEX PATH: U:\Bent\Projects\Clients\2509-Deschutes\Courty\297-2509-005-OBPH Design Phase\99Svc\CD\DWG\TUMALO RD RBA\CD\S\Tumalo rd-Tumalo pl PLOTTED BY: ricadev DATE: Monday, September 21, 2020 5:53:35 PM

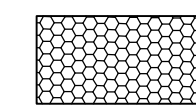
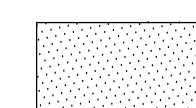
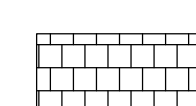

-  STAMPED CONCRETE SEE DETAIL 5/C4.0
-  OVERLAY & WIDENING SECTION SEE 2/C2.1
-  PERPETUAL SECTION PER 1/C2.0 AND 2/C2.0
-  FULL DEPTH SECTION SEE 3/C2.0, 1/C2.1

PAVING INDEX PLAN
SCALE IN FEET
0 50' 100'

REVISIONS	DATE	BY	DESIGNED
1	9/22/20	DR	
			DRAWN
			CHECKED
			APPROVED

ONE INCH AT FULL SCALE.
IF NOT, SCALE ACCORDINGLY

FILE NAME
BE2509005-C3.0-PI00

JOB No.
297-2509-005

DATE
05/2020



PROJECT NAME
**TUMALO RD / TUMALO PL
INTERSECTION IMPROVEMENTS**

PAVING INDEX

DRAWING NO.
5 OF 40

C3.0

LAYOUT: C7.0 PLAN & PROFILE PATH: U:\Road\Projects\Clients\2509-Deschutes County\297-2509-005 OBRH Design Phase\995\cs\TUMALO RD RBAs\CD'S\Tumalo rd-Tumalo.pl PLOTTED BY: ricardov DATE: Monday, September 21, 2020 2:18:48 PM

CURVE TABLE			
CURVE ID	LENGTH	RADIUS	DELTA
1	67.33'	250.00'	15°25'53"
2	598.82'	1425.00'	24°04'38"

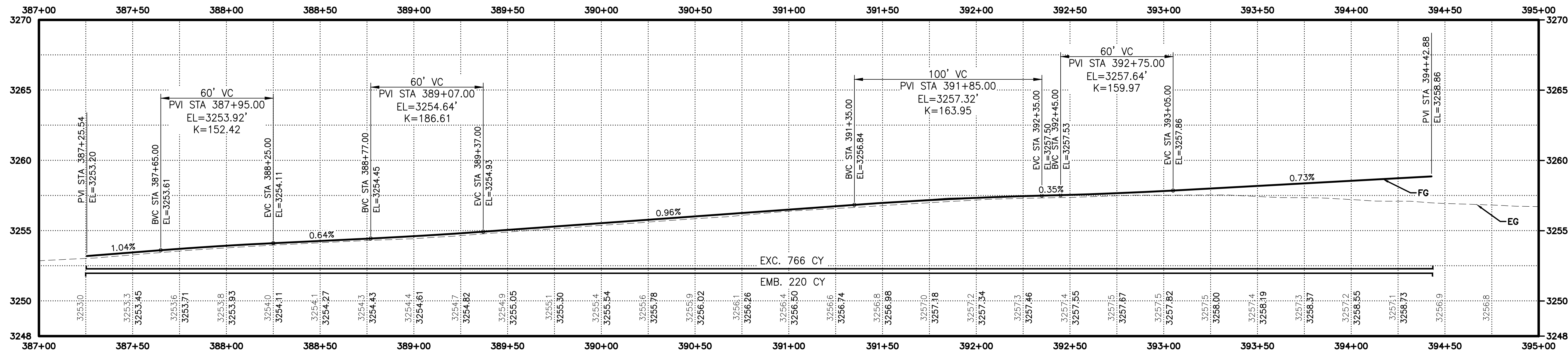
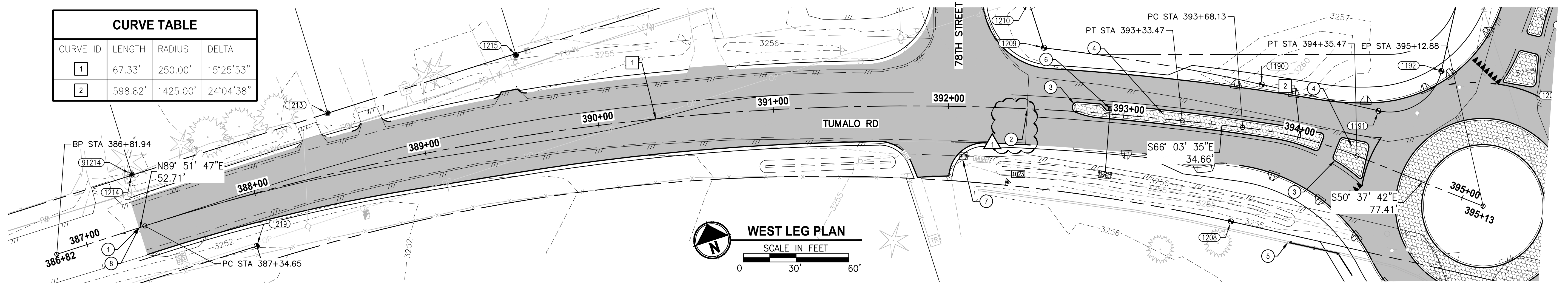

WEST LEG PROFILE
SCALE IN FEET
0 30' 60'

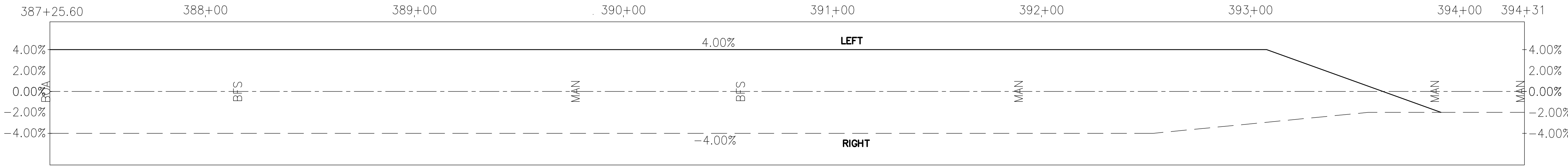

WEST LEG SUPER ELEVATION GRAPH
1"=30'

- ROAD CONSTRUCTION NOTES:**
- BEGIN ROAD CONSTRUCTION STA: 387+31.2
 - BEGIN FULL DEPTH CONSTRUCTION STA: 392+44.8
 - CONSTRUCT LOW PROFILE MOUNTABLE CURB (SEE DETAIL 1/C4.0)
 - CONSTRUCT STAMPED COLORED CONCRETE MEDIAN (SEE DETAIL 5/C4.0)
 - INSTALL SOUND WALL, SEE SHEET C9.0
 - INSTALL ODOT TYPE G-2 INLET STA: 392+92.03, 3.1' LT PER ODOT STD DWG RD 364 RIM=3257.83, I.E OUT = 3254.50 INSTALL 36.5 LF OF 8" DUCTIL IRON PIPE, S=0.01 FT/FT
 - INSTALL MAILBOX SUPPORT PER ODOT STD DWG RD 100
 - BEGIN 0'-2" GRIND TAPER PER 10/C4.0

REVISIONS	DATE	BY	DESIGNED DR
1	9/22/20	DR	DRAWN DR/LYF
			CHECKED
			APPROVED

ONE INCH AT FULL SCALE. IF NOT, SCALE ACCORDINGLY.
FILE NAME: BE2509005-C7.0-PP00
JOB No: 297-2509-005
DATE: 05/2020



PROJECT NAME
TUMALO RD / TUMALO PL INTERSECTION IMPROVEMENTS

WEST LEG - PLAN & PROFILE

DRAWING NO.
9 OF 40
C7.0

LAYOUT: C7.2 PLAN & PROFILE
 PATH: U:\Bend\Projects\Clients\2509-005 OBRH Design Phase\995\CD\TUMALO RD\BAA\CD\TUMALO RD\BAA\CD\TUMALO rd-Tumalo pl
 PLOTTED BY: ricodov DATE: Monday, September 21, 2020 5:20:02 PM

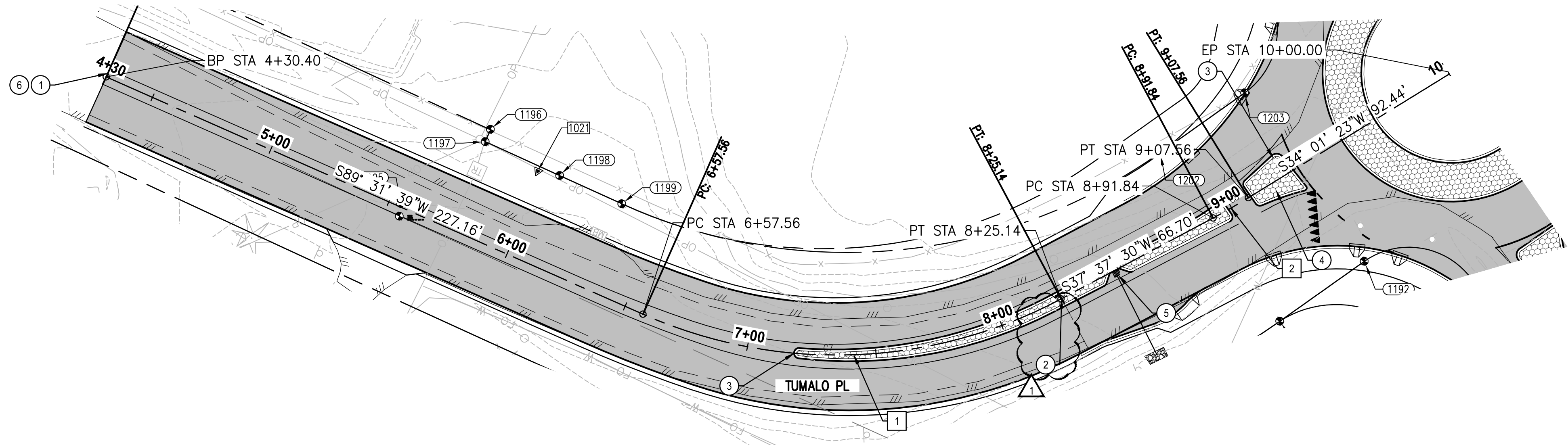

NORTH LEG PLAN
 SCALE IN FEET
 0 30' 60'

- ROAD CONSTRUCTION NOTES:**
- 1 BEGIN ROAD CONSTRUCTION STA: 4+30.4 PER 2/C2.1
 - 2 BEGIN FULL DEPTH CONSTRUCTION STA: 8+25.4 PER 2/C2.1
 - 3 CONSTRUCT LOW PROFILE MOUNTABLE CURB (SEE DETAIL 8/C4.0)
 - 4 CONSTRUCT STAMPED COLORED CONCRETE MEDIAN (SEE DETAIL 8/C4.0)
 - 5 INSTALL ODOT TYPE G-2 INLET STA: 8+48.6, 1.3RT PER ODOT STD DWG RD 364 RIM=3260.4, I.E OUT = 3257.74 INSTALL 35 LF OF 8" DUCTILE IRON PIPE, S=0.008 FT/FT
 - 6 BEGIN 0'-2" GRIND TAPER PER 10/C4.0

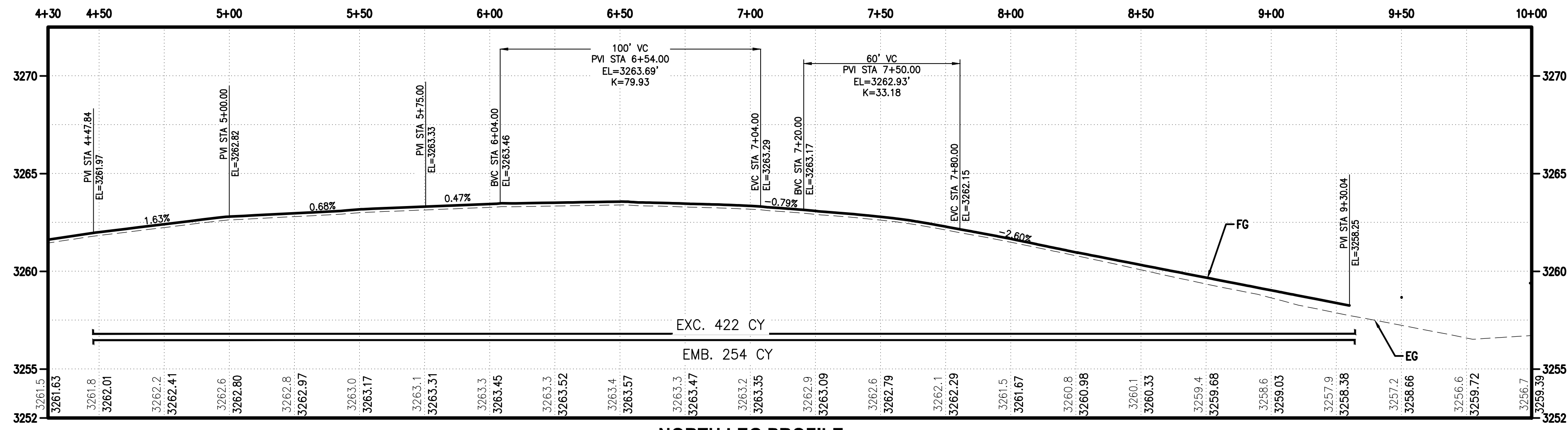

NORTH LEG PROFILE
 SCALE IN FEET
 0 30' 60'

CURVE TABLE			
CURVE ID	LENGTH	RADIUS	DELTA
1	167.59'	185.00'	51°54'10"
2	15.72'	250.00'	3°36'07"

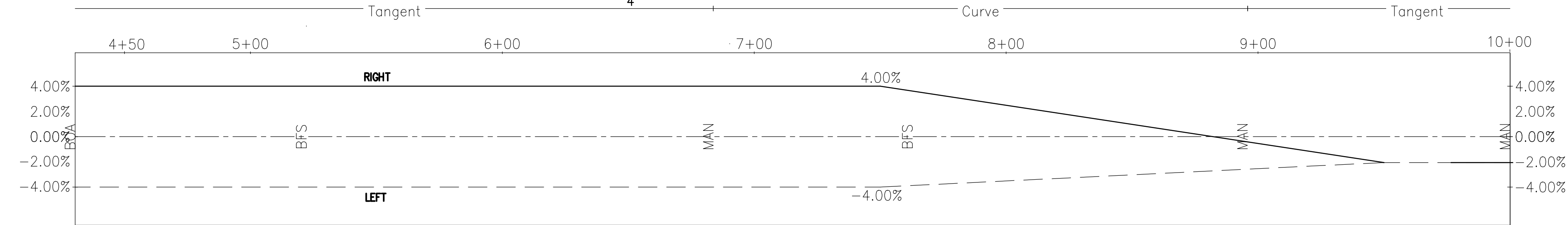

NORTH LEG SUPER ELEVATION GRAPH
 1"=30'

REVISIONS	DATE	BY	DESIGNED DR
1	9/22/20	DR	DRAWN DR/LYF
			CHECKED
			APPROVED

ONE INCH AT FULL SCALE. IF NOT, SCALE ACCORDINGLY

FILE NAME: BE2509005-C7.2-PP00
 JOB No: 2509-005
 DATE: 05/2020

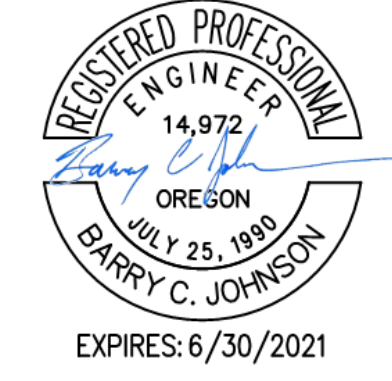

PROJECT NAME
TUMALO RD / TUMALO PL INTERSECTION IMPROVEMENTS

NORTH LEG - PLAN & PROFILE

DRAWING NO.
 11 OF 40
C7.2